



KIT CARRELLI

KIT CARRELLI AS300



Kit carrelli AS300 | Rollers kit AS300 | Kit chariots AS300 |
 Kit de ruedas AS300



Corpo in zama,
 costole, molle di
 regolazione e viti
 in acciaio inox,
 cuscinetti a sfera.



Zamak body, stainless
 steel springs and
 screws, bearing.



Corps en zamak,
 ressort et vis en acier
 inox, roulements à
 billes.



Cuerpo de zamac,
 muelles y tornillos de
 acero inox, bolas.

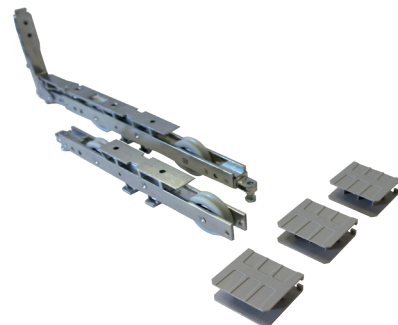

ART.	6740		
Imballo Package Conditionnement Embalaje	1 Pz		
Finiture disponibili Available finishes Finitions disponibles Acabados disponibles	2	3	4

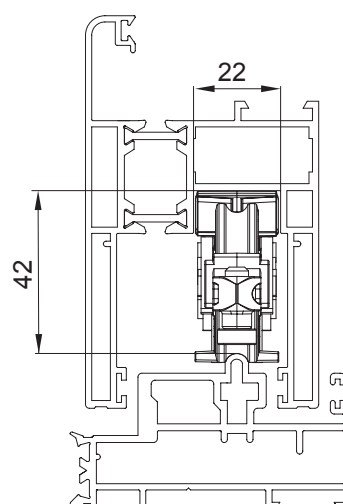
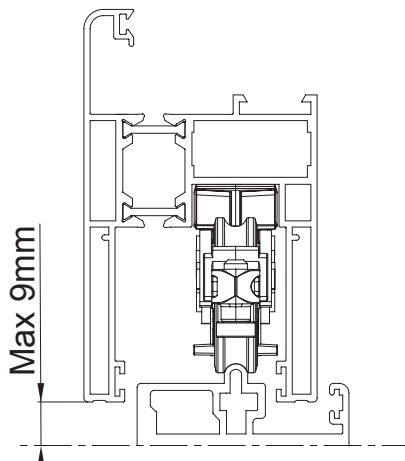
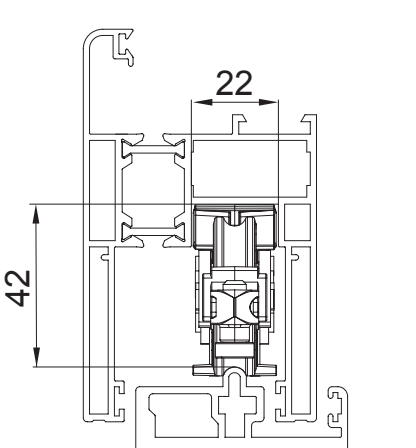
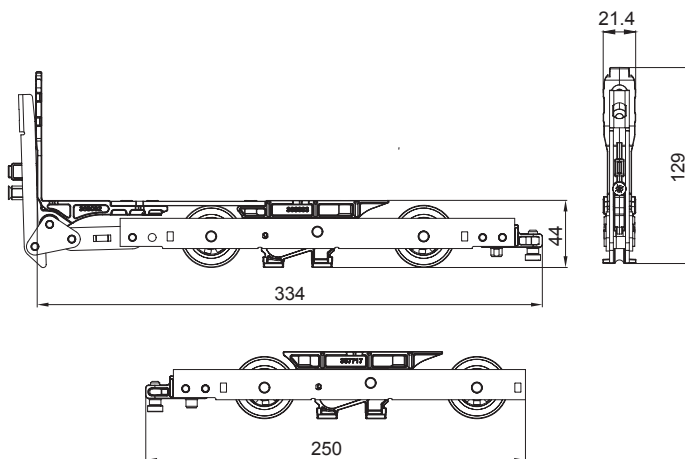
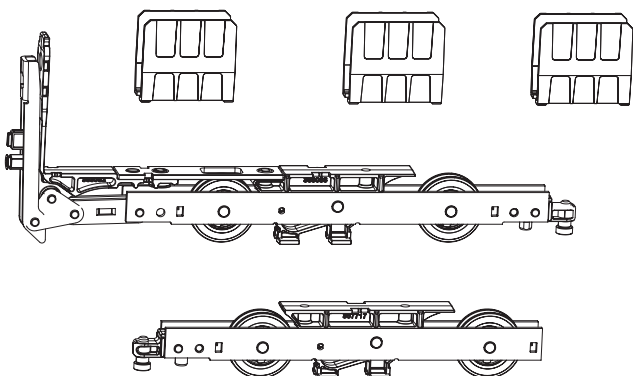



ART.	6742.XX 6743				6741.XX				6740.10				6742A.XX			
Imballo Package Conditionnement Embalaje	20 Pz				10 Pz				1 Cp				20 Pz			
Finiture disponibili Available finishes Finitions disponibles Acabados disponibles	1	2	3	4	1	2	3	4	1	2	3	4	1	2	3	4

6742.XX

Spessore verticale carrello anteriore
Vertical roller thickness

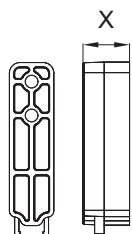

Art.	X	Art.	X
6742.20	20,5	6742.10	10
6742.22	22	6742.14	14
6742.25	25,5	6742.16	16
6742.30	30	6742.18	18
6742.32	32	6742.26	26
6742.36	36	6742.29	29

6741.X

Asta collegamento carrelli
Connection rod

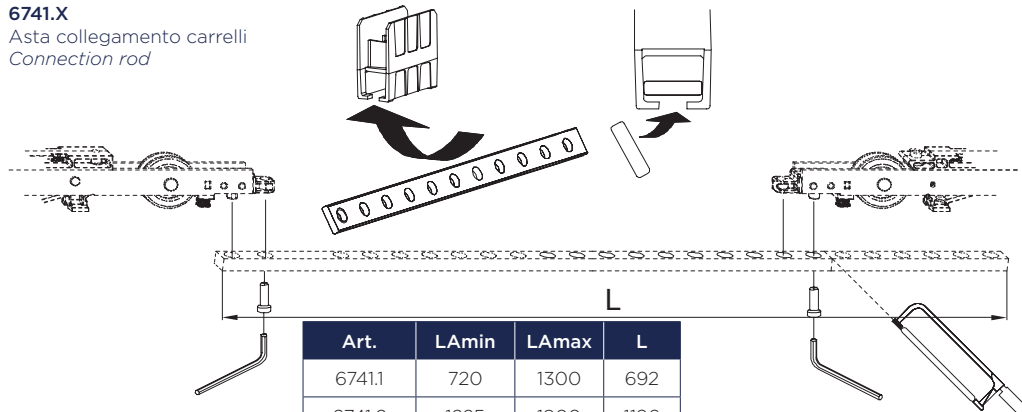

Art.	LAmin	LAmax	L
6741.1	720	1300	692
6741.2	1225	1800	1196
6741.3	1730	2305	1700
6741.4	2235	2810	2204
6741.5	2740	3385	2708

6742A.X

Spessore orizzontali carrelli
Horizontal roller thickness

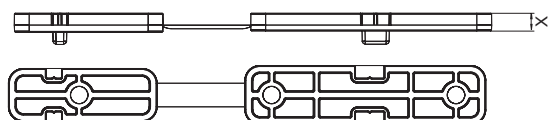

Art.	X	Art.	X
6742A.3	3	6742A.8	8
6742A.5	5	6742A.10	10
6742A.6	6		

6740.10

Carrello supplementare

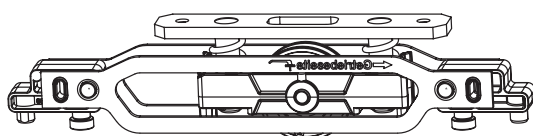

LAmin > 1200mm



6740.11

Carrello supplementare senza spazzole

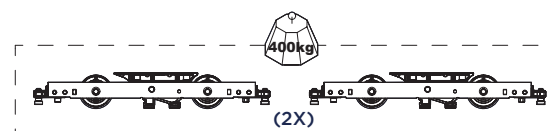
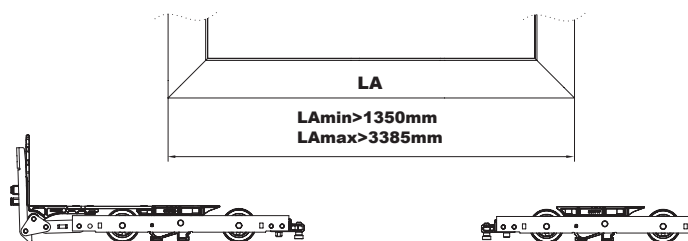

* Obbligatorio utilizzo art.6737
Mandatory use art.6737

6743

Sistema di sostegno
Support system

