

# SP160 - KIT CHIUSURE Cava Erre

## KIT CHIUSURE PERIMENTRALI VERSIONE MANUALE E SEMIAUTOMATICA



Kit chiusure perimentrali versione manuale e semiautomatica  
 Perimeter locking kit manual and semi-automatic version  
 Kit fermetures perimetrales version manuelle et semi-automatique  
 Kit de cierre perimetral en versión manual y semiautomática



Rinvio d'angolo, terminali e riscontri in zama, viti inox. Manuale fino a 100Kg. Semiautomatico fino a 160 Kg.



Transmission corner, rod ends and strikers in zamak. Stainless steel screws. Manual version up to 100 kg. Semi-automatic version up to 160 kg.



Renvoi d'angle, terminales et gâches en zamak, vis inox. Manuel jusqu'à 100Kg. Semi-automatique jusqu'à 160 Kg.



Ángulo de reenvío, terminal y cerraderos en zamak, tornillos en inox. Versión manual hasta 100 kg. Versión semiautomática hasta 160 kg.

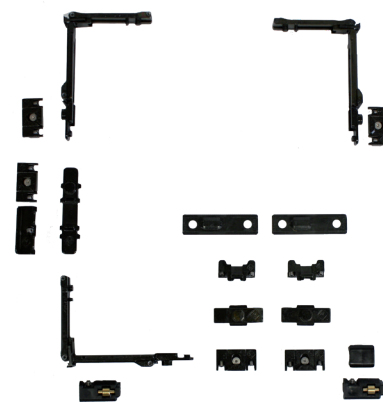

ART.	3921.1   3921.2				
Imballo   Package   Conditionnement   Embalaje	1 Pz				
Finiture disponibili   Available finishes Finitions disponibles   Acabados disponibles	<table border="1"> <tr> <td>1</td> <td>2</td> <td>3</td> <td>4</td> </tr> </table>	1	2	3	4
1	2	3	4		

Art. 3921.1 Kit base - Manuale  
Base kit - Manual

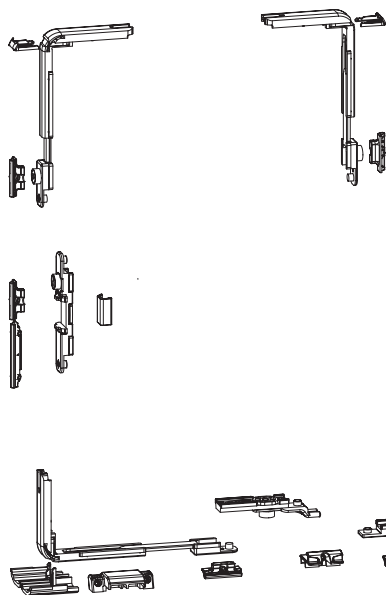

Max  
100 kg



Chiusura | Locking



Scorrevole | Slide



Ribalta | Tilt

\* Portata max 100 Kg / Dimensione max 1280 x H 2380

Riferimento nodo ERRE  
ERRE system section riferiment

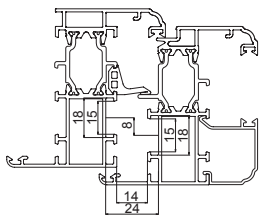

Art	Nodo   Section
3921.1 3921.2	A08

Art. 3921.2 Kit base - Semiautomatico  
Base kit - Semiautomatic

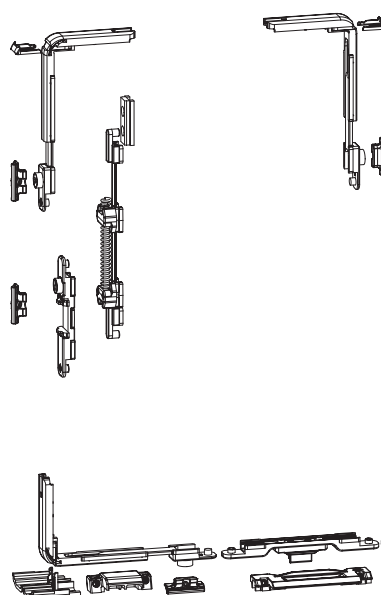

Max  
160 kg



Chiusura | Locking

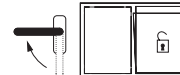

Ribalta | Tilt



Scorrevole | Slide

\* Portata max 160 Kg / Dimensione max L 1680 x H 2380

REGOLAZIONI | ADJUSTEMENT

