



# BLOCCHETTO DI COLLEGAMENTO



Blocchetto di collegamento | Connecting block  
Bloc de jonction | Bloqueo de unión



Blocchetto in zama;  
compensatori cursori  
in nylon; inserti in  
delrin.



Zamak block; nylon  
sliders compensators;  
delrin inserts



Bloc en zamak;  
compensateurs  
cursours en nylon;  
inserts en delrin.



Bloqueo en zamac;  
compensadores de  
los cursores en nylon;  
insertos en delrin.



ART.	TUTTI   ALL   TOUS   TODOS			
Imballo   Package   Conditionnement   Embalaje	20 Pz			
Finiture disponibili   Available finishes Finitions disponibles   Acabados disponibles	1	2	3	4

Art. 6111.1

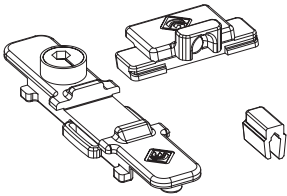

Art. 6111.21

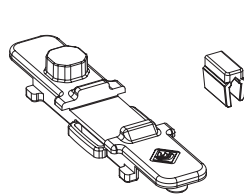

Art. 6111.6

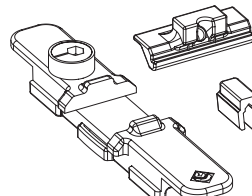

Art. 6111.3

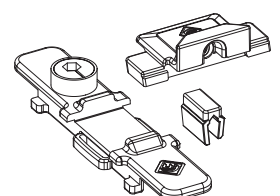

Art. 6111.13

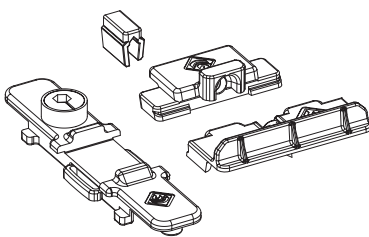

Art. 6111.14

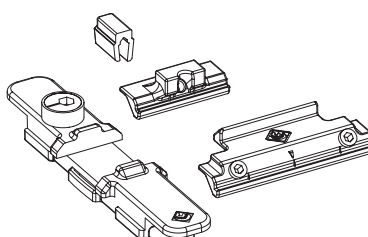

Art. 6111.15

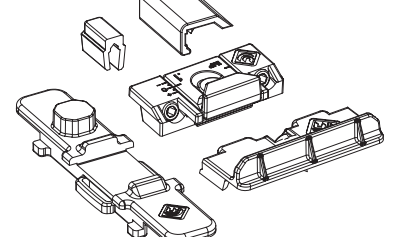

DESCRIZIONE DESCRIPTION	ART.	NODO SECTION
Kit con riscontro art. 4207.1, da abbinare alla cremonese art. 6010.21 <i>Kit with striker ref. 4207.1, to combine with cremone-bolt ref. 6010.21</i>	6111.1	A01 - A02 - A03 - A05 - A06
Kit con riscontro art. 4207.4, da abbinare alla cremonese art. 6010.21 <i>Kit with striker ref. 4207.4, to combine with cremone-bolt ref. 6010.21</i>	6111.3	A01 - A02 - A03 - A05 - A06
Kit con riscontro art. 4270.2, da abbinare alla cremonese art. 6010.21 <i>Kit with striker ref. 4207.2, to combine with cremone-bolt ref. 6010.21</i>	6111.6	A08 - A23
Kit senza riscontro, da abbinare alla cremonese art. 6010.21 <i>kit without striker, to combine with cremone-bolt ref. 6010.21</i>	6111.21	A01 - A02 - A03 - A05 - A06
Kit con riscontro art. 4207.2, da abbinare alla cremonese art. 6011.10 <i>Kit with striker ref. 4207.2, to combine with cremone-bolt ref. 6011.10</i>	6111.14	A08 - A23
Kit con riscontro art. 4207.1, da abbinare alla cremonese art. 6011.10 <i>Kit with striker ref. 4207.1, to combine with cremone-bolt ref. 6011.10</i>	6111.13	A01 - A02 - A05 - A06
Kit con riscontro art. 4207.11, da abbinare alla cremonese art. 6011.10 <i>Kit with striker ref. 4207.11, to combine with cremone-bolt ref. 6011.10</i>	6111.15	A01 - A02 - A05 - A06