



## PUNTI DI CHIUSURA SUPPLEMENTARE



Punti di chiusura supplementare | Extra locking pin  
Pivot de fermeture supplementaire | Pernio de cierre suplementario



Perno e vite M5  
TSP CR in acciaio  
zincato. Art. 4246  
eccentrico di chiusura  
in zama, regolabile  
in pressione in 8  
posizioni diverse.  
Riscontro in zama.



Pin and M5 TSP  
CR screw in  
galvanized steel.  
Art. 4246 locking  
cam in zamak, with  
adjustable pressure in  
8 different positions.  
Zamak striker.



Pivot et vis M5 TSP  
CR en acier zingué.  
Art. 4246 came de  
fermeture en zamak,  
réglable en pression  
avec 8 positions  
différentes.  
Gache en zamak.



Pernio y tornillo M5  
TSP CR de acero  
galvanizado. Art. 4246  
excéntrica de cierre  
de zamak, regulable  
a presión en 8  
posiciones diferentes.  
Encuentro de zamak.



ART.	4241   4241.1   4242   4246   4246.1   4246.10 4246.11   4246.14   4246.15   4207.1   4207.2 4207.11   4207.4   4207.21   3421.32   3520.32	4246.1   4248.1 4248.11   4248.12	3400F.32
Imballo   Package   Conditionnement   Embalaje	50 Pz	20 Pz	25 Pz
Finiture disponibili   Available finishes Finitions disponibles   Acabados disponibles	1 2 3 4	1 2 3 4	1 2 3 4

### 1 424X

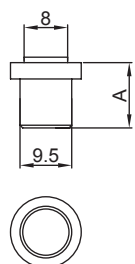

ART.	A
4241	9
4241.1	10.5
4242	12

### 2 4246

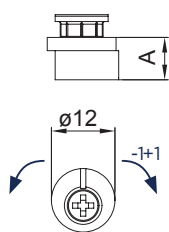

ART.	A
4246	8

### 3 4246.1

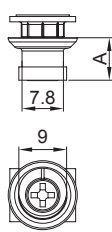

Abbinabile con la  
cremonese art. 6010.12  
Compatible with  
cremone-bolt art. 6010.12

ART.	A
4246.1	8

### 4 4248.1

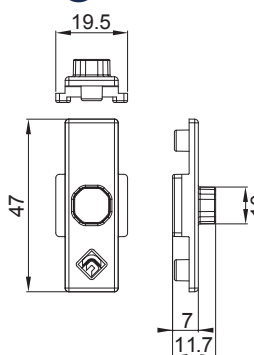

ART.	NODO SECTION
4248.1	A01 - A03 - A05 A20 - A21 - A22 B01 - B03

### 5 4248.1X

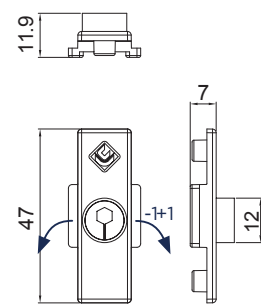

ART.	NODO SECTION
4248.11	A01 - A03 - A05 A20 - A21 - A22 B01 - B03
4248.12	A08 - B04

### 6 4207.2

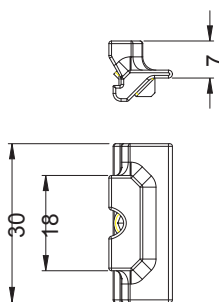

ART.	NODO SECTION
4207.2	A08 - B04

### 7 4207.1

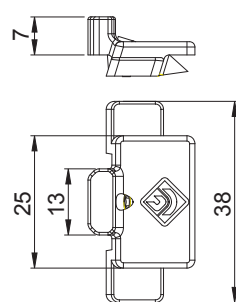

ART.	NODO SECTION
4207.1	A01 - A03 - A05 A20 - A21 - A22 B01 - B03

### 8 4207.4

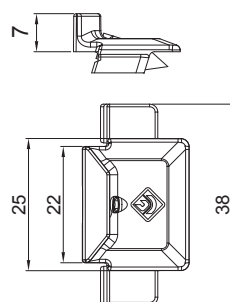

ART.	NODO SECTION
4207.4	A01 - A03 - A05 - A20 - A21 A22 B01 - B03

### 9 4207.11

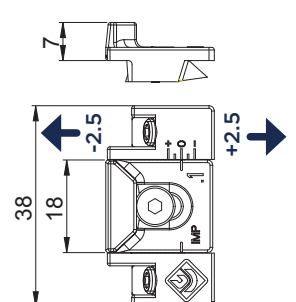

ART.	NODO SECTION
4207.11	A01 - A03 - A05 - A20 A21 - A22 B01 - B03

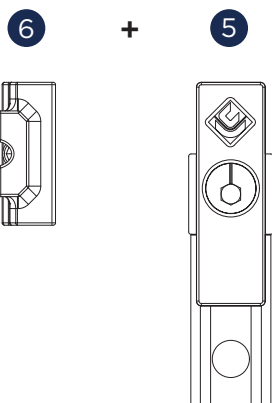

ART.	NODO SECTION
3421.32	A08 - B04

RESISTENZA ALL'APERTURA CON ASTINA IN POLIAMMIDE  
RESISTANCE TO OPENING WITH POLYAMIDE ROD **F = 2000N**

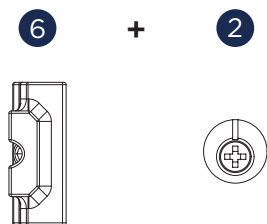

ART.	NODO SECTION
4246.10	A08 - B04

RESISTENZA ALL'APERTURA CON ASTINA IN POLIAMMIDE  
RESISTANCE TO OPENING WITH POLYAMIDE ROD **F = 2000N**

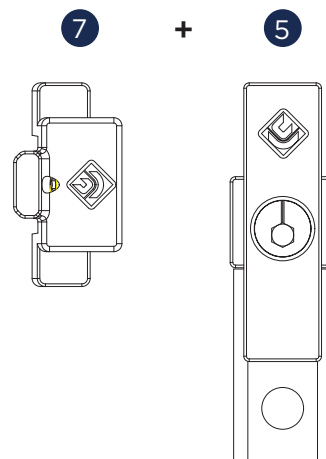

ART.	NODO SECTION
3520.32	A01 - A03 - A05 - A20 -A21 - A22 B01 - B03

RESISTENZA ALL'APERTURA CON ASTINA IN POLIAMMIDE  
RESISTANCE TO OPENING WITH POLYAMIDE ROD **F = 2000N**

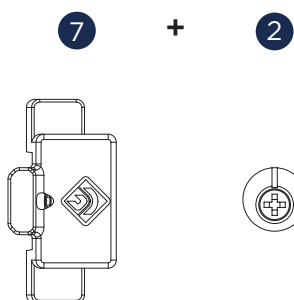

ART.	NODO SECTION
4246.11	A01 - A03 - A05 - A20 -A21 - A22 B01 - B03

RESISTENZA ALL'APERTURA CON ASTINA IN POLIAMMIDE  
RESISTANCE TO OPENING WITH POLYAMIDE ROD **F = 2000N**

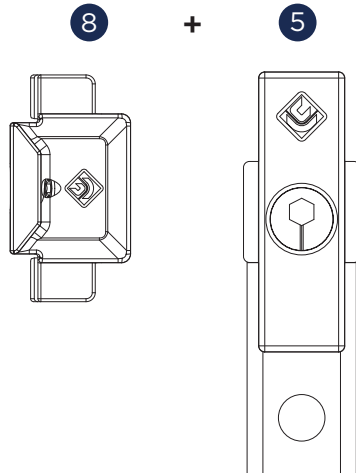

ART.	NODO SECTION
4207.21	A01 - A03 - A05 - A20 -A21 - A22 B01 - B03

RESISTENZA ALL'APERTURA CON ASTINA IN POLIAMMIDE  
RESISTANCE TO OPENING WITH POLYAMIDE ROD **F = 2200N**

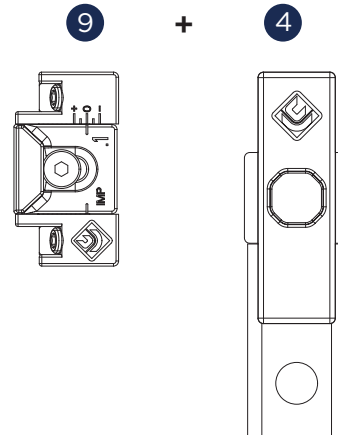

ART.	NODO SECTION
3400F.32	A01 - A03 - A05 - A20 -A21 - A22 B01 - B03

RESISTENZA ALL'APERTURA CON ASTINA IN POLIAMMIDE  
RESISTANCE TO OPENING WITH POLYAMIDE ROD **F = 1800N**

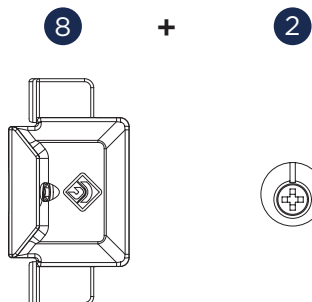

ART.	NODO SECTION
4246.15	A01 - A03 - A05 - A20 -A21 - A22 B01 - B03

RESISTENZA ALL'APERTURA CON ASTINA IN POLIAMMIDE  
RESISTANCE TO OPENING WITH POLYAMIDE ROD **F = 2000N**

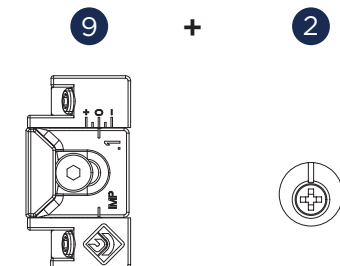

ART.	NODO SECTION
4246.14	A01 - A03 - A05 - A20 -A21 - A22 B01 - B03

RESISTENZA ALL'APERTURA CON ASTINA IN POLIAMMIDE  
RESISTANCE TO OPENING WITH POLYAMIDE ROD **F = 2000N**

**METODO DI PROVA  
TEST METHOD**

Martinetto pneumatico che spinge sul punto di chiusura  
*Pneumatic jack that pushes on the closing point*