

Movimentazione monodirezionale con antifalsamanovra

Mono-directional movement mechanism with anti-false manoeuvre

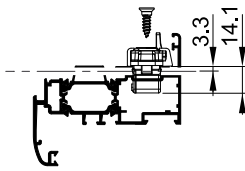
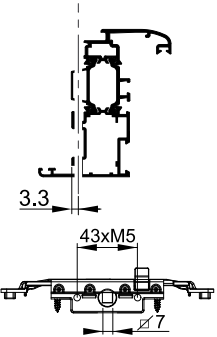
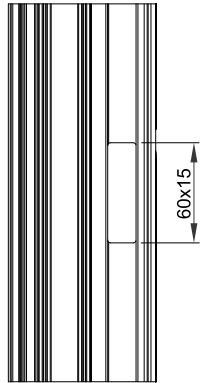
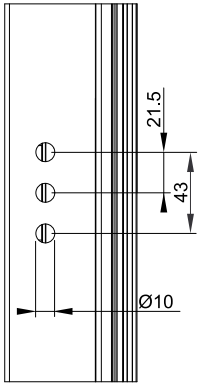

Compatibile con martelline serie
3070 - 3072 - 3073 - 3080

Suitable with handles:
3070 - 3072 - 3073 - 3080

1

Fasi di montaggio
Mounting steps

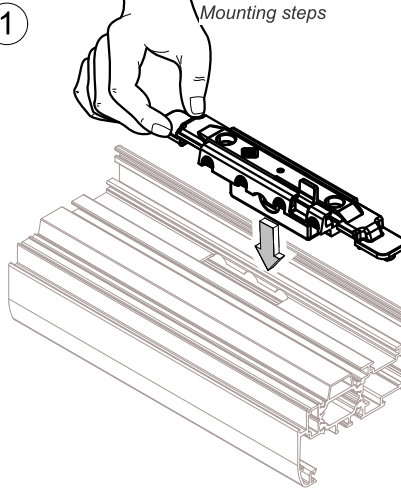

2

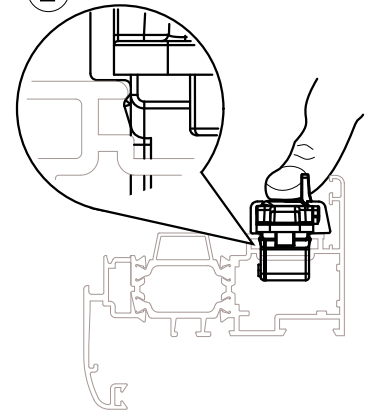

3

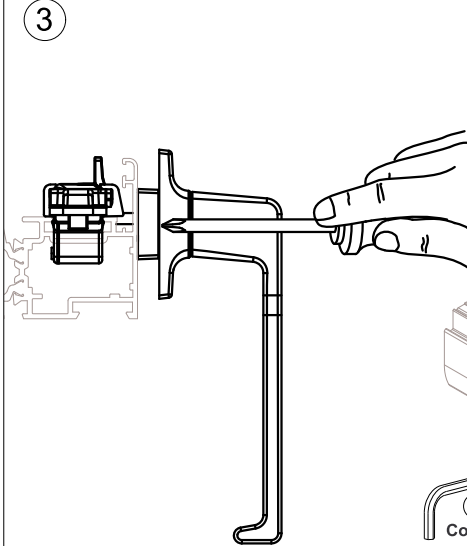

4

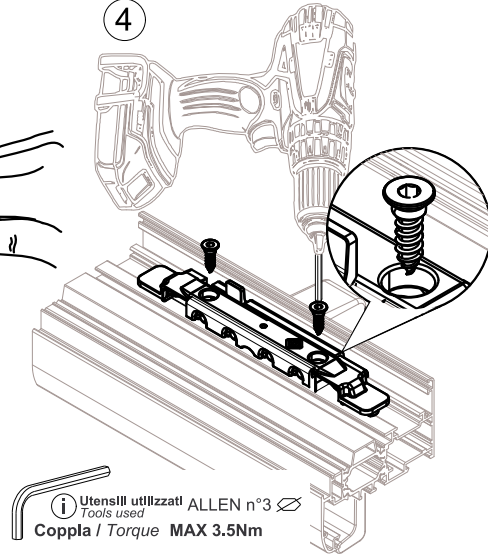

Utensili utilizzati ALLEN n°3
Tools used
Coppla / Torque MAX 3.5Nm

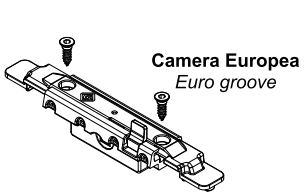

Riferimento nodo Camera Europea
Euro groove section referimnt

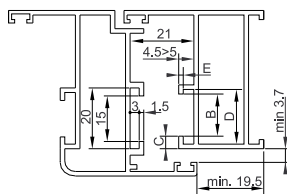

B	C	D	E
14	4	18	1.5
13.5	3.2	16.8	2.4
12	2.9	15	1.5
10	4.2	14.5	1.5

3630.20
Movimentazione monodirezionale con antifalsamanovra
Mono-directional movement mechanism with anti-false manoeuvre

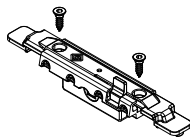

3630.30
Movimentazione monodirezionale senza antifalsamanovra
Mono-directional movement mechanism without anti-false manoeuvre

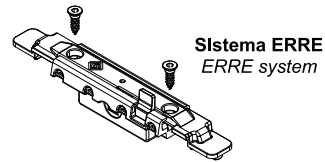

Riferimento nodo sistema ERRE
ERRE system section referimnt

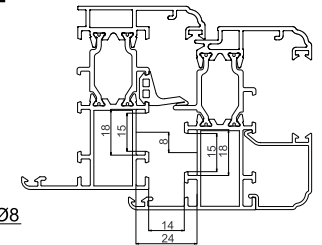

3631.20
Movimentazione monodirezionale con antifalsamanovra
Mono-directional movement mechanism with anti-false manoeuvre

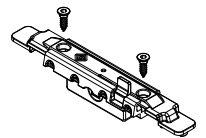

3631.30
Movimentazione monodirezionale senza antifalsamanovra
Mono-directional movement mechanism without anti-false manoeuvre

Punto di chiusura supplementare (opzionali)
Additional locking point (optional)



Punto di chiusura supplementare (opzionali)
Additional locking point (optional)

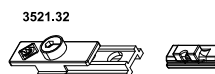

**Schema taglio astine generale anta ribalta
con movimentazione monodirezionale Shark**

*General instruction of machining for Tilt and
Turn with unidirectional movement Shark*

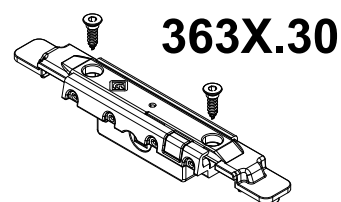
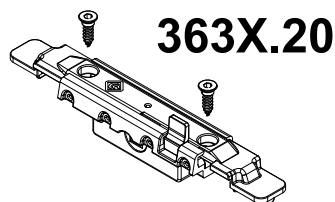

Camera Europea | Euro groove **3630.20 - 3630.30**
Camera Erre | Erre groove **3631.20 - 3631.30**

Art.3420F/G/N.1



3630.20

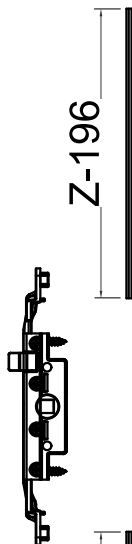

Y-166

Ween

Camera Europea | Euro groove

Art.3450F/G/N.1

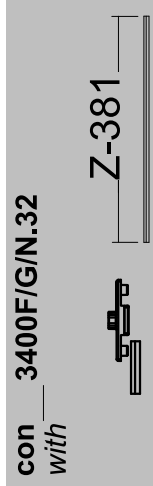

3630.30

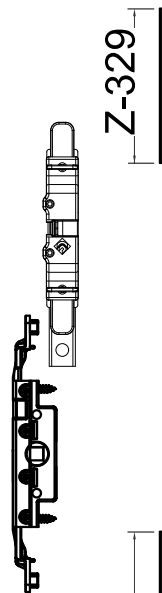

Y-166

Ween

Camera Europea | Euro groove

Art.3421G.1

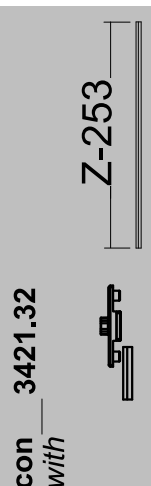

3631.20

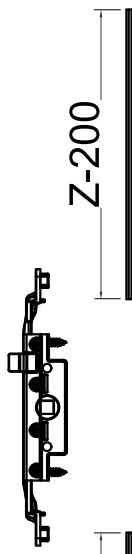

Y-225

Ween

Camera Erre | Erre groove

Art.3451G.1

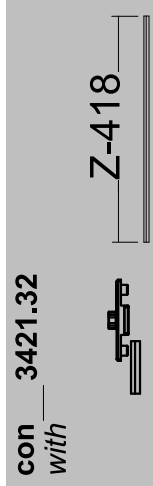

3631.30

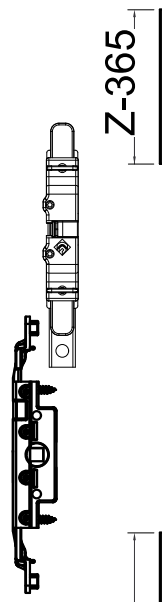

Y-225

Ween

Camera Erre | Erre groove