

## Telaio - Frame

### Lavorazioni / Machining

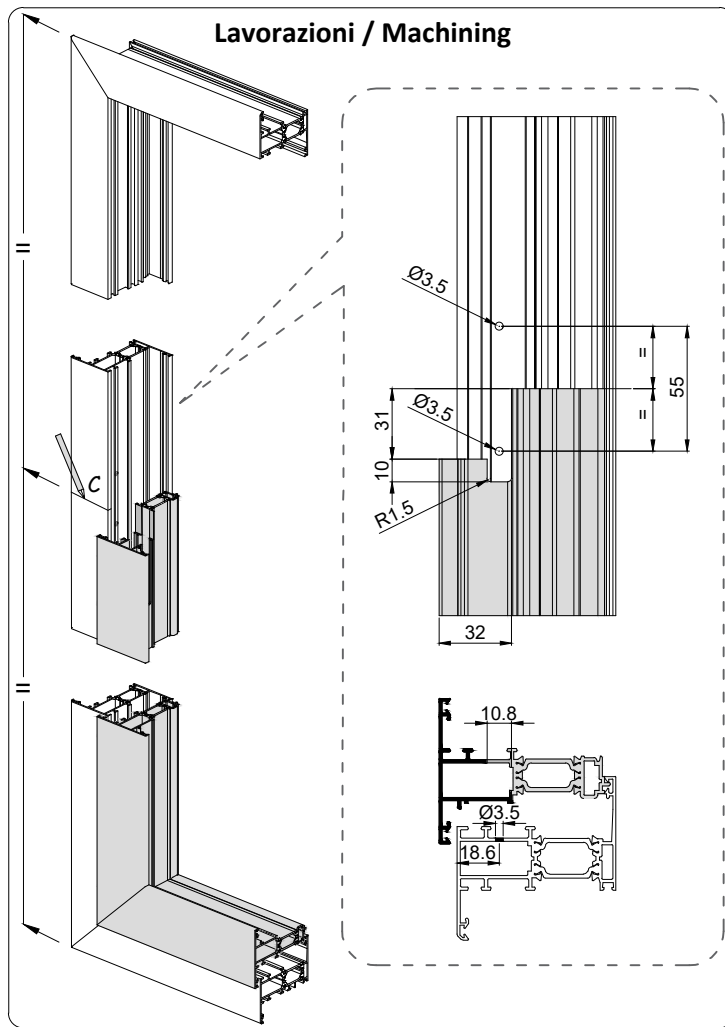

### Montaggio / Assembly

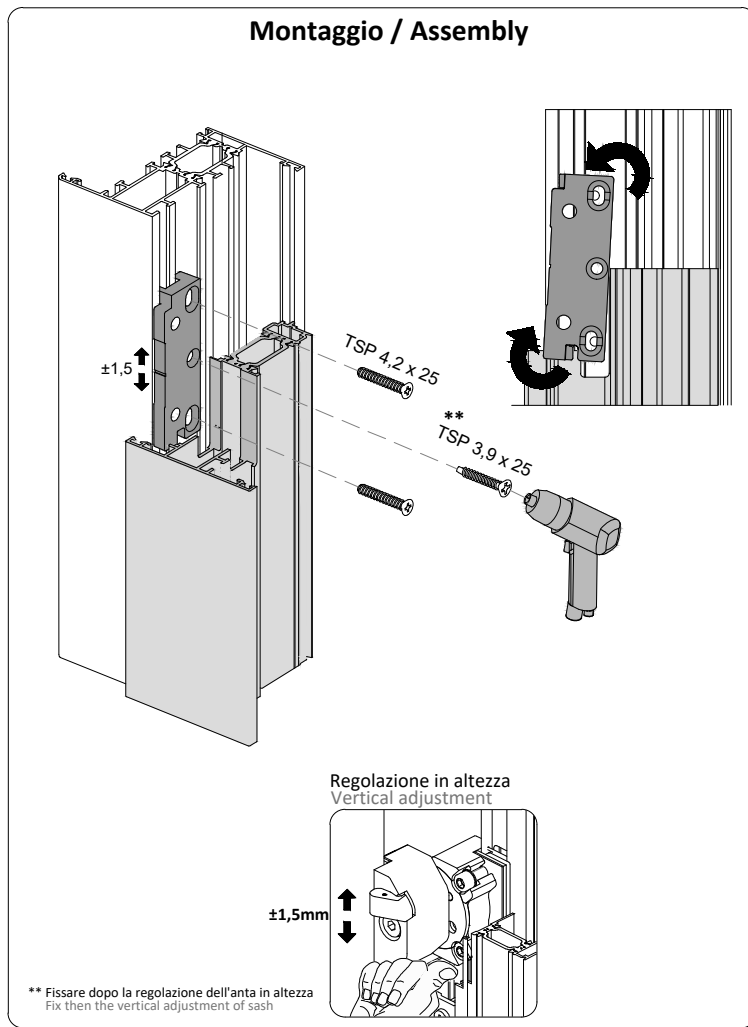

SCHEDA TECNICA DI MONTAGGIO

# EasyPivot

<http://www.masteritaly.com>

CERNIERA A FRIZIONE PER FINESTRE BILICO ORIZZONTALI E VERTICALI  
FRICTION HINGE FOR HORIZONTAL AND VERTICAL PIVOT WINDOWS

Per Camera Erre - For Erre groove

**Kit cerniere orizzontale con blocco**  
Hinges kit for horizontal with lock  
**3700**

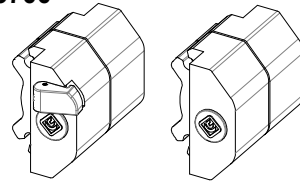

**Kit cerniere verticale senza blocco**  
Hinges kit for vertical without lock  
**3700.10**

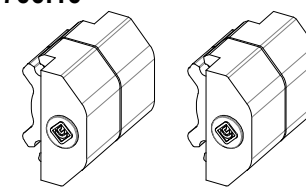

**Kit fissaggio cerniere**  
Fixing hinges kit  
**3711**

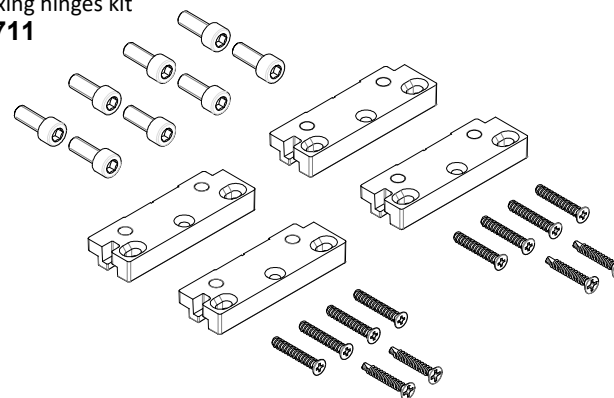

**Kit chiusura perimetrale**  
Multi-point locking kit  
**3711.10**

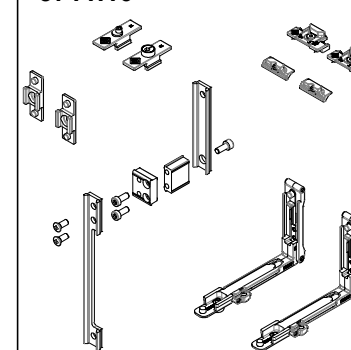

**Kit chiusura supp. orizzontale**  
Additional locking kit for horizontal  
**3711.20**

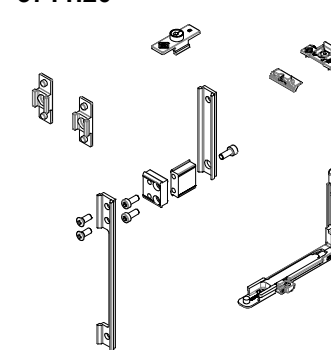

**Distanziale di fissaggio di riporto**  
Fastening joint for profile  
**3711.40**

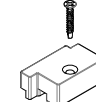

Ogni 500 mm (min. 2 per lato)  
Every 500 mm (min. 2 for side)

Riferimento nodosistema ERRE  
ERRE system section referiment

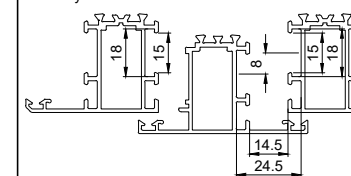

**Kit chiusura supp. verticale**  
Additional locking kit for vertical  
**3711.30**

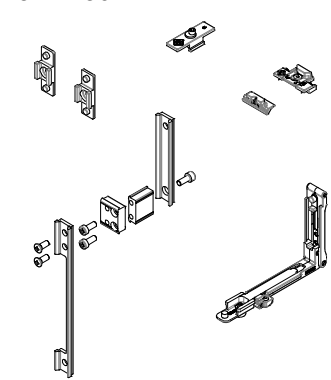

Norma di riferimento Europea UNI EN 13126-1:2006 / 13126-9:2006  
Certified according to European Standard UNI EN 13126-1:2006 / 13126-9:2006

Hor.	5	120	0	1	4	-	9/1	1400x1400
Ver.	5	80	0	1	4	-	9/3	1400x1400
Categoria d'uso	Durabilità	Massa	Resistenza fuoco	Sicurezza di utilizzo	Resistenza alla corrosione	Resistenza effrazione	Applicazione	Dimensione di prova
Category of use	Durability	Mass	Fire resistance	Safety in use	Corrosion resistance	Security	Applicable part	Test size

## Anta - Sash

### Lavorazioni / Machining

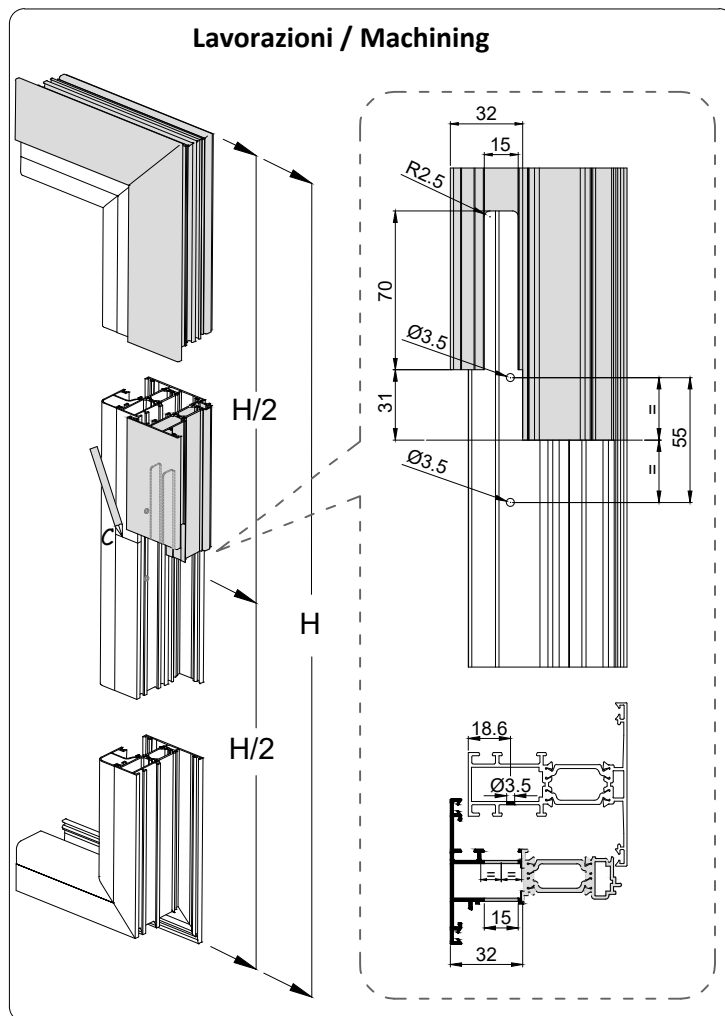

### Montaggio / Assembly

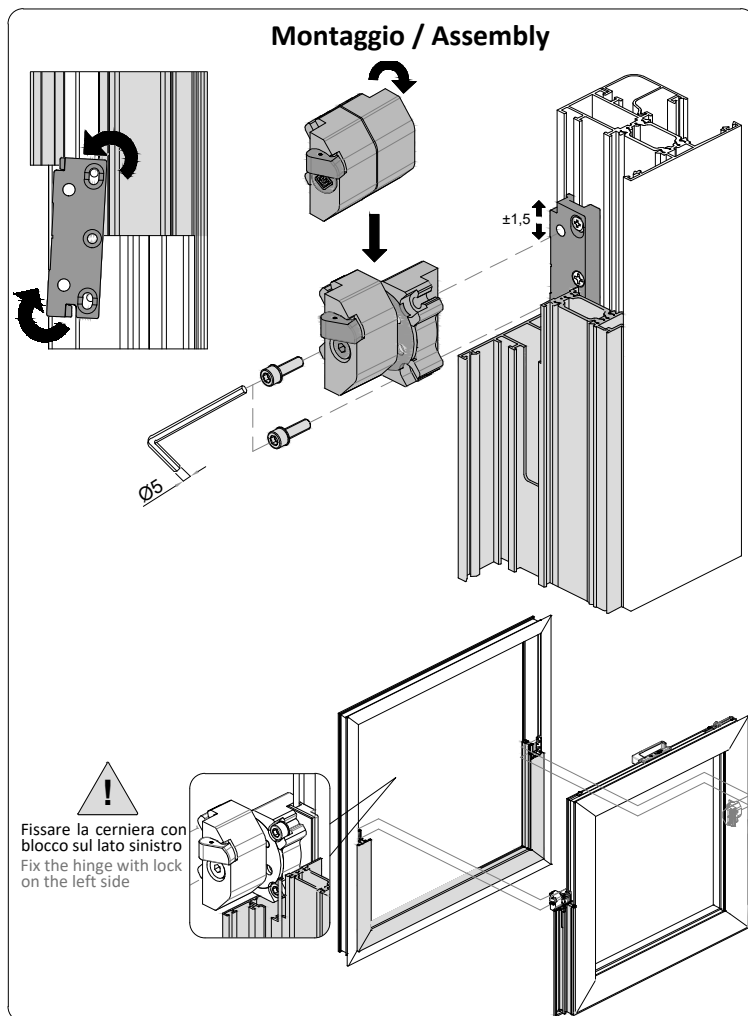

### Section 1

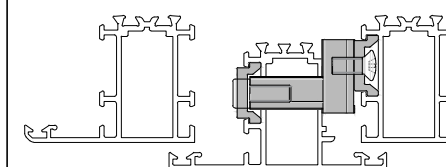

### Section 2A

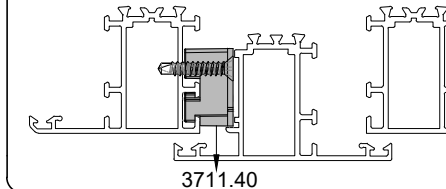

3711.40

### Section 2B

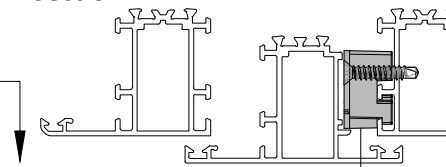

3711.40

## Diagramma di carico - Application range

### Horizontal

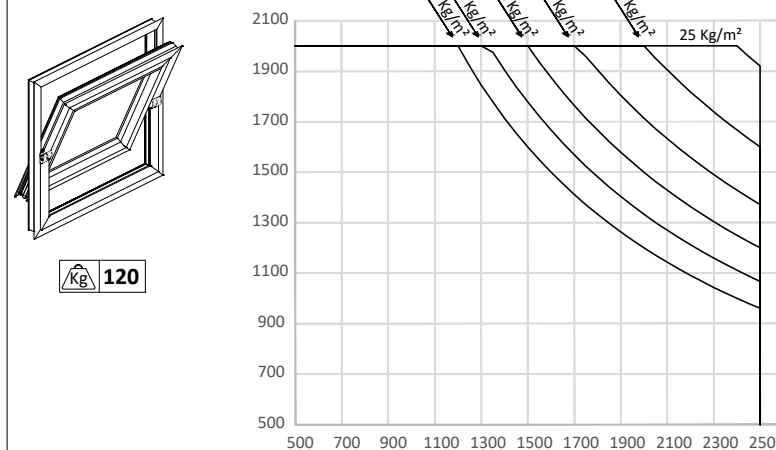

### Vertical

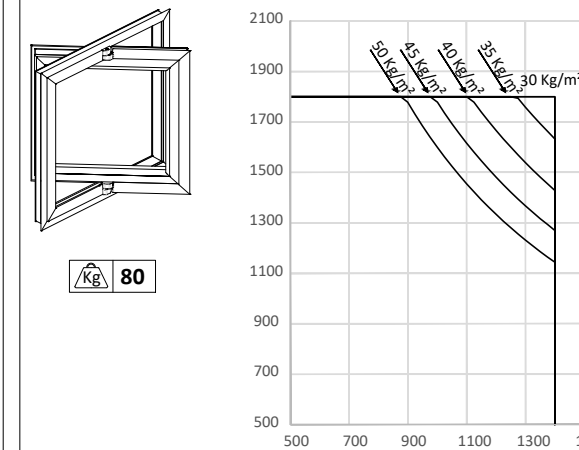

# Horizontal Pivot Window

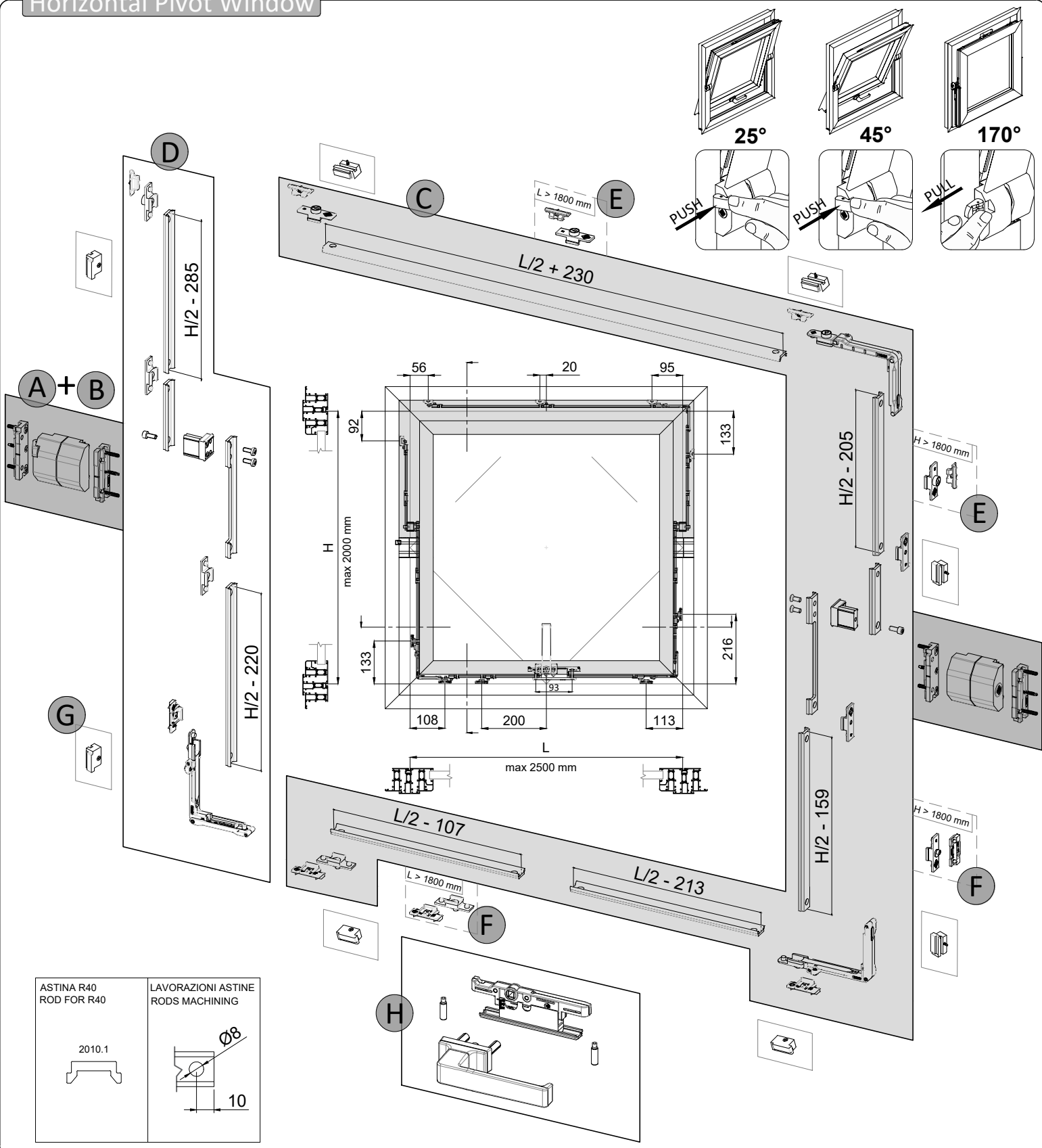

# Vertical Pivot Window

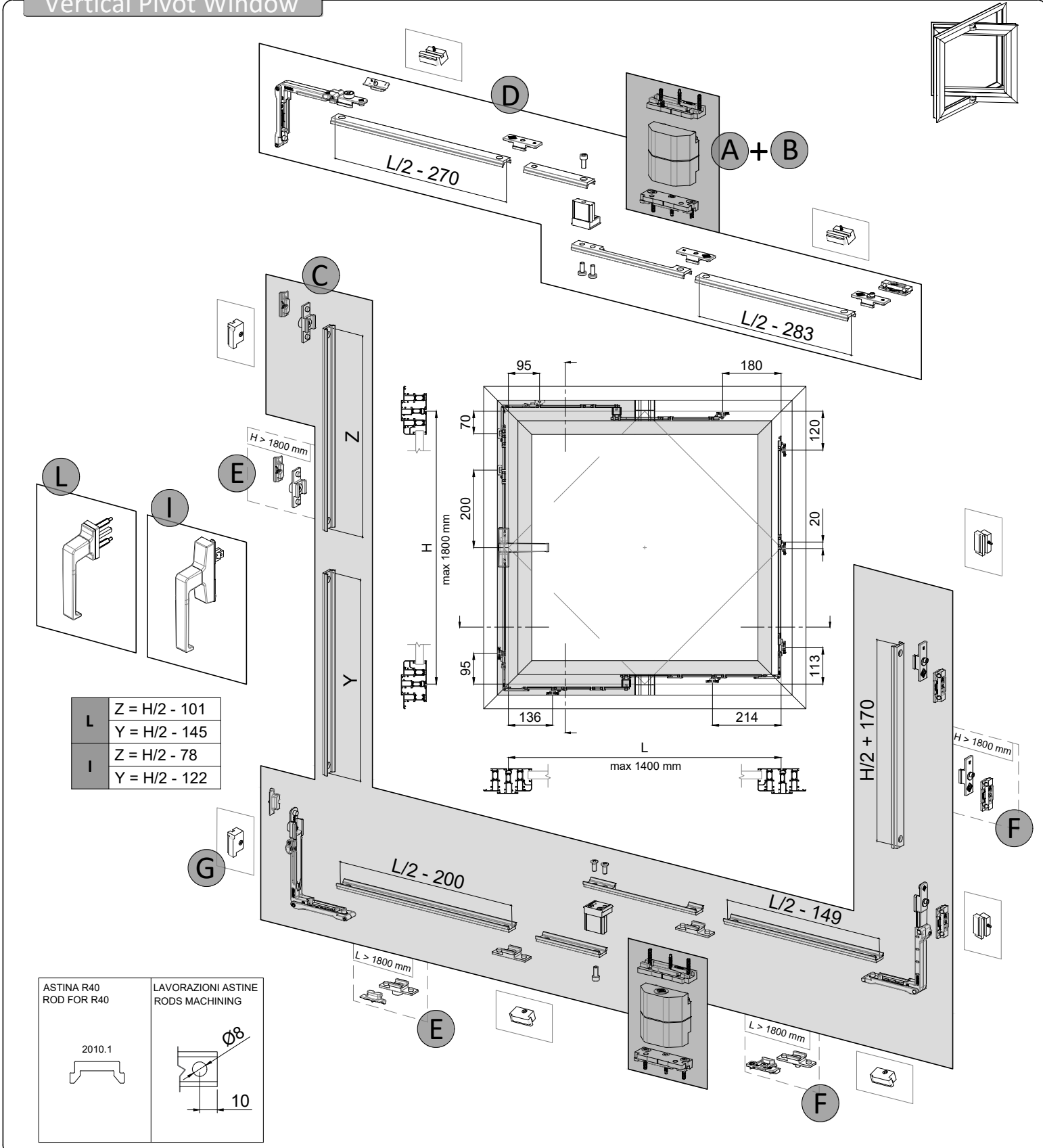

## Distinta accessori / Accessories list

H 2000	A	3700	1 cp	A	3700	1 cp
	B	3711	1 pz	B	3711	1 pz
	C	3711.10	1 pz	C	3711.10	1 pz
	D	3711.20	1 pz	D	3711.20	1 pz
	E	4207.2 + 4248.12	1 pz	E	4207.2 + 4248.12	2 pz
	F	4207.11 + 4248.13	1 pz	F	4207.11 + 4248.13	2 pz
	G	3711.40	10 pz	G	3711.40	12 pz
H 1800	A	3700	1 cp	A	3700	1 cp
	B	3711	1 pz	B	3711	1 pz
	C	3711.10	1 pz	C	3711.10	1 pz
	D	3711.20	1 pz	D	3711.20	1 pz
	G	3711.40	8 pz	G	3711.40	10 pz
H 550	A	3700	1 cp	A	3700	1 cp
	B	3711	1 pz	B	3711	1 pz
	G	3711.40	8 pz	G	3711.40	10 pz

**Maniglie**  
Handles

3070      3072      3100 - 3100.1

**E**  
4207.2 + 4248.12

**H** Altri accessori  
Other accessories

3626.2      6420E.XX

**F**  
4207.11 + 4248.13

## Distinta accessori / Accessories list

H 1800	A	3700.10	1 cp	A	3700.10	1 cp
	B	3711	1 pz	B	3711	1 pz
	C	3711.10	1 pz	C	3711.10	1 pz
	D	3711.30	1 pz	D	3711.30	1 pz
	E	4207.2 + 4248.12	1 pz	E	4207.2 + 4248.12	2 pz
	F	4207.11 + 4248.13	1 pz	F	4207.11 + 4248.13	2 pz
	G	3711.40	10 pz	G	3711.40	12 pz
H 1000	A	3700.10	1 cp	A	3700.10	1 cp
	B	3711	1 pz	B	3711	1 pz
	C	3711.10	1 pz	C	3711.10	1 pz
	D	3711.30	1 pz	D	3711.30	1 pz
	G	3711.40	8 pz	G	3711.40	10 pz
H 550	A	3700.10	1 cp	A	3700.10	1 cp
	B	3711	1 pz	B	3711	1 pz
	G	3711.40	8 pz	G	3711.40	10 pz

**Maniglie**  
Handles

3070      3072      3100 - 3100.1

**L**

**I**

**Altri accessori**  
Other accessories

3628 - 3628.2

6015 - 6011.10      6061      6018      6111.14

**E**  
4207.2 + 4248.12

**F**  
4207.11 + 4248.13