

**REGOLAZIONE
ADJUSTMENT**

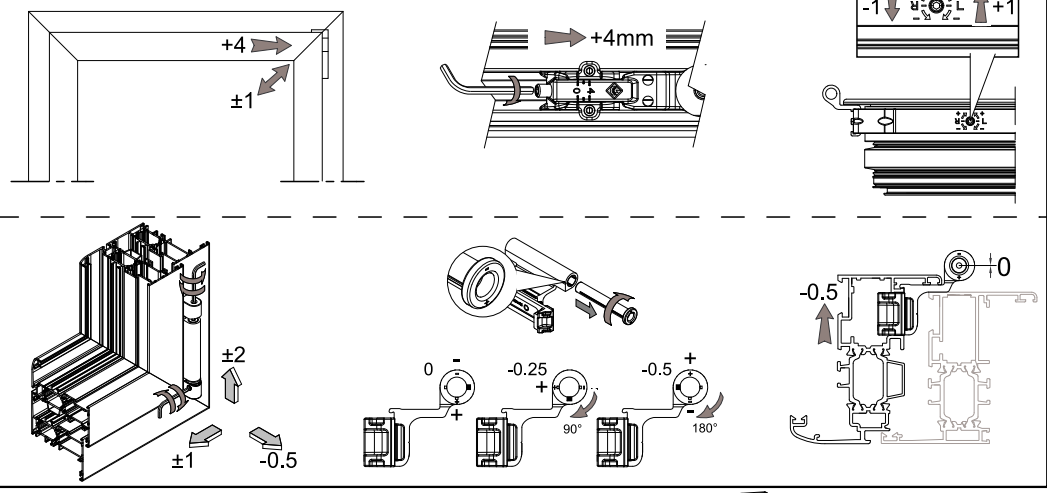

3400.24		3400F.1 / 3400F.151 3400F.401											3420.24		3420F.1 / 3420F.150 3420F.151 / 3420F.158 / 3420F.401														
100 Kg		3400LF.1											160 Kg		3420LF.1														
2700	40	37	30	25	21	19	16	15	13	12	11	11	2700	50	50	47	40	34	30	26	24	22	20	18	17	16	15	14	
2600	42	38	31	26	22	19	17	15	14	13	12	11	2600	50	50	49	41	35	31	27	25	22	21	19	18	16	15	14	
2500	43	40	32	27	23	20	18	16	15	13	12	11	2500	50	50	50	43	37	32	28	26	23	21	20	18	17	16	15	
2400	45	42	33	28	24	21	19	17	15	14	13	12	2400	50	50	50	44	38	33	30	27	24	22	21	19	18	17	16	
2300	47	43	35	29	25	22	19	17	16	14	13	12	2300	50	50	50	46	40	35	31	28	25	23	21	20	19	17	16	
2200	49	45	36	30	26	23	20	18	17	15	14	13	2200	50	50	50	48	42	36	32	29	26	24	22	21	19	18	17	
2100	50	48	38	32	27	24	21	19	17	16	15	14	2100	50	50	50	50	44	38	34	30	28	25	23	22	20	19	16	
2000	50	50	40	33	29	25	22	20	18	17	15	14	2000	50	50	50	50	46	40	36	32	29	27	25	23	21	20	17	
1900	50	50	42	35	30	26	23	21	19	18	16	15	1900	50	50	50	50	48	42	37	34	31	28	26	24	22	19	17	
1800	50	50	44	37	32	28	25	22	20	19	17	16	1800	50	50	50	50	44	40	36	32	30	27	25	21	20	19	17	
1700	50	50	47	39	34	29	26	24	21	20	18	15	1700	50	50	50	50	47	42	38	34	31	29	24	23	21	20	17	
1600	50	50	50	42	36	31	28	25	23	21	17	16	1600	50	50	50	50	50	44	40	36	33	28	26	24	23	18	17	
1500	50	50	50	44	38	33	30	27	24	22	18	17	1500	50	50	50	50	50	47	43	39	36	30	27	26	20	15	14	
1400	50	50	50	48	42	37	30	27	25	21	20	18	1400	50	50	50	50	50	46	42	34	32	29	23	17	16	15	14	
1300	50	50	50	50	44	38	34	31	25	23	21	18	1300	50	50	50	50	50	49	40	37	34	26	20	18	12	12	6	
1200	50	50	50	50	48	42	37	30	27	25	19	14	1200	50	50	50	50	50	48	44	40	31	23	21	13	6	6	6	
1100	50	50	50	50	50	45	36	33	30	23	17	16	1100	50	50	50	50	50	50	48	36	27	25	16	7	X	X	X	
1000	50	50	50	50	50	50	40	36	27	20	18	11	1000	50	50	50	50	50	50	44	32	30	18	9	X	X	X	X	
900	50	50	50	50	50	50	44	27	24	15	7	X	900	50	50	50	50	50	50	43	39	24	11	X	X	X	X	X	
800	50	50	50	50	50	50	33	30	18	8	X	X	800	50	50	50	50	50	50	48	29	13	X	X	X	X	X	X	
700	50	50	50	50	50	43	38	11	X	X	X	X	700	50	50	50	50	50	50	18	X	X	X	X	X	X	X	X	
600	50	50	50	50	50	33	15	X	X	X	X	X	600	50	50	50	50	50	24	X	X	X	X	X	X	X	X	X	X
500	50	50	50	50	46	X	X	X	X	X	X	X	500	50	50	50	50	X	X	X	X	X	X	X	X	X	X	X	X

Con 3400L.22 H anta min.700 mm
With 3400L.22 H sash min. 700 mm

20	IT	Anta eseguibile con spessore vetro Max 20 mm	X	IT	Dimensione non eseguibile
	EN	Sash size executable with Max glass thickness 20 mm		EN	Not feasible

Norma di riferimento Europea UNI EN 13126-1:2006 / 13126-8:2006 | Certified according to European Standard UNI EN 13126-1:2006 / 13126-8:2006

1550x1400	4	160	0	1	4	-	8	-
Dimensione di prova	Durabilità	Massa	Resistenza fuoco	Sicurezza di utilizzo	Resistenza alla corrosione	Resistenza effrazione	Applicazione	Categoria d'uso
Test size	Durability	Mass	Fire resistance	Safety in use	Corrosion resistance	Security	Applicable part	Category of use

Kit anta ribalta versione F con AFM su cremone
Kit for tilt and turn version F with AFM on the cremone bolt
Per sistemi Camera Europea
For Euro Groove system

3400F.1 / 3420F.1 / 3420F.158
3400F.401 / 3420F.401
3420F.150 / 3400F.151 / 3420F.151
3400LF.1 / 3420LF.1

Riferimento nodo Camera Europea
Euro groove section referment

B	C	D	E
14	4	18	1.5
13.5	3.2	16.8	2.4
12	2.9	15	1.5
10	4.2	14.5	1.5

ITA ESP
ENG FRA

LAVORAZIONI / MACHINING

NOTE: nel caso di utilizzo cremone con interasse 98mm utilizzare Part. 6015.3
NOTE: in case of cremone-bolt with inter-axe 98mm use art. 6015.3

LAVORAZIONI ASTINE
RODS MACHINING

Maniglie
Handles

6018	6038 6038.20D/S	6015 - 6015.3 6011 - 6011.10	6036 - 6032.10 - 6036.3 6036.20D/S - 6036.23D/S	6061	6063 6063.20
3072	3077.2 3077.25D/S	3070	3070.2 3075.25D/S	3100	3101 3101.25

MASTER S.r.l. - I616A - A3 FR - 03/02/2021

Posizionamento punti chiusura kit base | Base kit locking points positioning

ANTA RIBALTA | TILT AND TURN

AFM

Ribalta Tilt
Apertura Open
Chiusura Locking

3400F.1 / 3420F.1 / 3420F.158 / 3400F.401
3420F.401 / 3420F.150 / 3400F.151 / 3420F.151

MANOVRA LOGICA | TILT BEFORE TURN

AFM

Apertura Open
Ribalta Tilt
Chiusura Locking

3400LF.1 / 3420LF.1

3420.24

⚠ **OBBLIGATORIO PER PESI > 100kg**
MANDATORY FOR WEIGHT > 100kg
OBLIGATOIRE POUR LES POIDS > 100 kg
OBLIGATORIO DE PESO > 100kg

14.9
3.3

160kg

3400.50

Ø3.5

Utensili utilizzati ALLEN n°3
 Coppla / Torque MAX 3.5Nm

3400.24

100kg

Utensili utilizzati ALLEN n°3
 Coppla / Torque MAX 3.5Nm

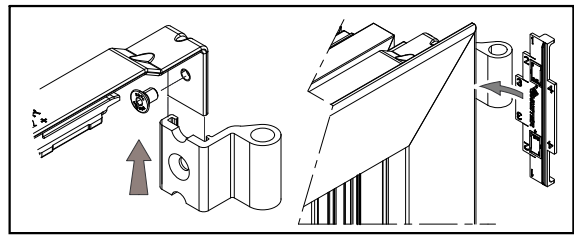

*** Perno microventilazione integrata**
Da abbinare a 3400.39
Built-in microventilation pin
In combination with 3400.39

⚠

PER L>500 E APERTURA IMPEDITA A 180°
 BRACCIO LIMITATORE CONSIGLIATO
 IT IS RECOMMENDED TO USE A LIMITER ARM FOR WINDOWS WIDTH >500 AND FOR WINDOWS WITH 180° RESTRICTED OPENING

10"

1203A.10
 >390mm <1701mm

Telajo - Frame

Anta - Sash

255

MANOVRA LOGICA - TBT
 3550L.30 + 3400L.22

L - 692

ANTA RIBALTA - T&T
 3550.30 + 3400.22

L-965

1200 mm < L ≤ 1700 mm

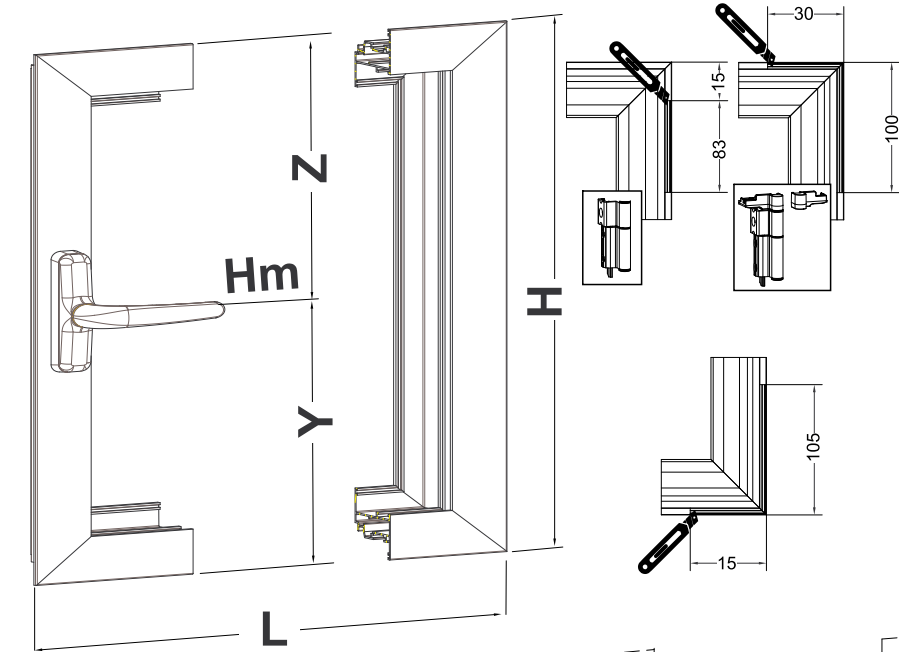

* 3400.22 3400L.22

L - 543

651 mm < L ≤ 1200 mm

* 3400.21 3400L.21

L - 356

451 mm < L ≤ 650 mm

3400.20 3400L.20

L - 340

369 mm < L ≤ 451 mm

3400F.1 / 3420F.1 / 3420F.158 / 3400F.401 / 3420F.151 / 3420F.151 / 3400L.F.1 / 3420L.F.1

Z - 166

Y - 132

Z - 246

Y - 163

3627F.1 / 3627F.3

Z-249

Y - 166

3630F.1 / 3630F.30

3400.24

3420.24

LOGICA DOPPIA ANTA TBT
 DOUBLE SASH

(a)	Y - 140
(b)	Y - 171
(c)	Y - 174

3420F.31

H/2 - 166

H > 1400 mm

L/2 - 132

3400.35

L > 1200 mm

H/2 - 400

H > 2200 mm

3400F.32

**REGOLAZIONE
ADJUSTMENT**

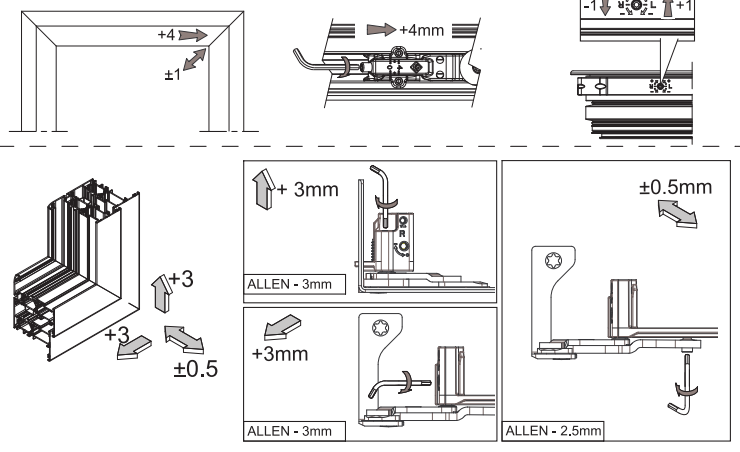

120Kg - 110°

2700	44	36	30	25	22	20	18	16	15	14	13	12	11	10	
2600	46	37	31	26	23	21	18	17	15	14	13	12	11		
2500	48	38	32	27	24	21	19	17	16	15	14	13	12	11	
2400	50	40	33	29	25	22	20	18	17	15	14	13	12		
2300	50	42	35	30	26	23	21	19	17	16	15	14	13	12	
2200	50	44	36	31	27	24	22	20	18	17	16	15	14	13	
2100	50	46	38	33	29	25	23	21	19	18	16	15	14	12	
2000	50	48	40	34	30	27	24	22	20	18	17	16	15	13	
1900	50	50	42	36	32	28	25	23	21	19	18	17	14	13	
1800	50	50	44	38	33	30	27	24	22	21	19	16	15	14	
1700	50	50	47	40	35	31	28	26	24	22	18	17	16	15	
1600	50	50	50	43	38	33	30	27	25	21	19	18	17	13	
1500	50	50	50	46	40	36	32	29	27	22	21	19	15	11	
1400	50	50	50	49	43	38	34	31	26	24	22	17	13	12	
1300	50	50	50	50	46	41	37	30	28	26	20	15	14	9	
1200	50	50	50	50	44	36	33	30	18	17	16	10	5		
1100	50	50	50	50	44	39	36	22	20	19	12	6	X		
1000	50	50	50	50	48	43	26	24	22	14	7	X	X		
900	50	50	50	50	50	32	29	18	8	X	X	X	X		
800	50	50	50	50	40	36	22	11	X	X	X	X	X		
700	50	50	50	50	46	14	X	X	X	X	X	X	X		
600	50	50	50	50	40	19	X	X	X	X	X	X	X		
550	50	50	50	50	X	X	X	X	X	X	X	X	X		
H	L	430	500	600	700	800	900	1000	1100	1200	1300	1400	1500	1600	1700

150Kg - 90°

2700	50	44	37	32	28	25	22	20	19	17	16	15	14	13	
2600	50	46	38	33	29	26	23	21	19	18	16	15	14	14	
2500	50	48	40	34	30	27	24	22	20	18	17	16	15	14	
2400	50	50	42	36	31	28	25	23	21	19	18	17	16	15	
2300	50	50	43	37	33	29	26	24	22	20	19	17	16	15	
2200	50	50	45	39	34	30	27	25	23	21	19	18	17	16	
2100	50	50	48	41	36	32	29	26	24	22	20	19	18	15	
2000	50	50	50	43	38	33	30	27	25	23	21	20	19	14	
1900	50	50	50	45	39	35	32	29	26	24	23	21	18	17	
1800	50	50	50	48	42	37	33	30	28	26	24	20	19	18	
1700	50	50	50	50	44	39	35	32	29	27	23	21	20	19	
1600	50	50	50	50	47	42	38	34	31	26	24	23	21	17	
1500	50	50	50	50	50	44	40	36	33	28	26	24	19	14	
1400	50	50	50	50	50	48	43	39	32	30	28	21	16	15	
1300	50	50	50	50	50	46	38	35	32	25	18	17	11		
1200	50	50	50	50	50	45	41	38	23	21	20	13	6		
1100	50	50	50	50	50	50	49	45	27	25	23	15	6	X	
1000	50	50	50	50	50	50	50	33	30	28	17	7	X	X	
900	50	50	50	50	50	50	40	36	22	10	X	X	X		
800	50	50	50	50	50	50	45	27	11	X	X	X	X		
700	50	50	50	50	50	50	17	X	X	X	X	X	X		
600	50	50	50	50	50	19	X	X	X	X	X	X	X		
550	50	50	50	50	X	X	X	X	X	X	X	X	X		
H	L	430	500	600	700	800	900	1000	1100	1200	1300	1400	1500	1600	1700

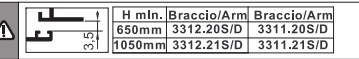

Indicazioni di taglio Anta Sash machining indication H - 1mm



Kit anta ribalta a scomparsa | Per sistemi Camera Europea
Hidden kit for tilt and turn | For Euro Groove system

ITA

ENG

Riferimento nodo Camera Europea
Euro groove section referment

3311xx A03 3312xx A01 - A02

H - 1mm

ANTA SASH
H - 1mm

L

LAVORAZIONI / MACHINING

6015.3
6036.3
6036.23D/S

6018
6038
6015
6011
6011.10
6036
6036.20D/S
6036.10
6038.20D/S
6061
6063
6063.20

6011
6011.10
6032.10

3072
3077.2
3070
3100
3077.25D/S
3101
3075.25D/S
3101.25

LAVORAZIONI ASTINE
RODS MACHINING

Mantiglie
Handles

6018

6038
6038.20D/S

6015 - 6015.3
6011 - 6011.10

6036 - 6032.10 - 6036.3
6036.20D/S
6036.23D/S

6061

6063
6063.20

3072

3077.2
3077.25D/S

3070

3075.25D/S

3100

3101
3101.25

MASTER S.r.l. - I-617B - A3 FR - 22/06/2024

Posizionamento punti chiusura | Positioning locking points | Positionnement points de fermeture | Posicionamiento puntos de cierre

ANTA RIBALTA | TILT AND TURN

AFM →

Ribalta Tilt
Apertura Open
Chiusura Locking

3320F.1

Z - 166

Y - 132

Hm

0

MANOVRA LOGICA | TILT BEFORE TURN

AFM →

Apertura Open
Ribalta Tilt
Chiusura Locking

3320LF.1

Z - 166

Y - 132
Y - 140

Hm

52

**MONTAGGIO CERNIERA INFERIORE
BOTTOM HINGE ASSEMBLY**

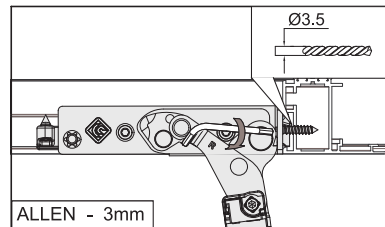
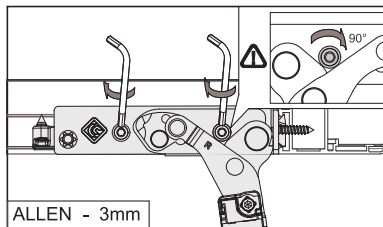
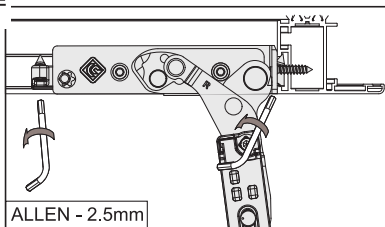
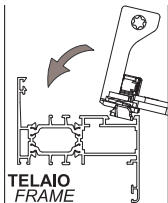

**MONTAGGIO CERNIERA SUPERIORE
TOP HINGE ASSEMBLY**

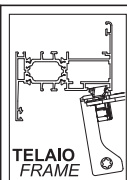
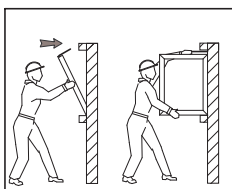
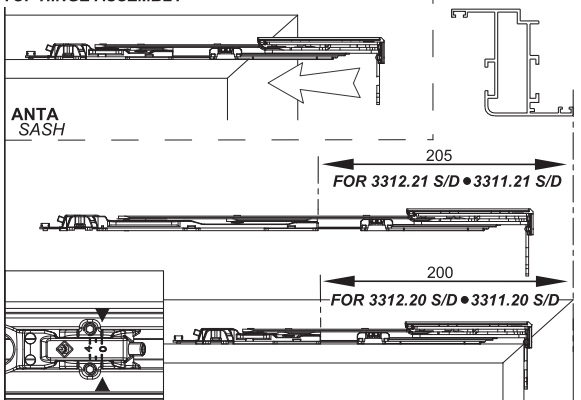

⚠
Per fissare la cerniera superiore sul telaio, seguire le istruzioni per il fissaggio della cerniera inferiore
To fix the top hinge on the frame, follow the instructions for the fixing of the bottom hinge

* Da abbinare a 3520.39
In combination with 3520.39

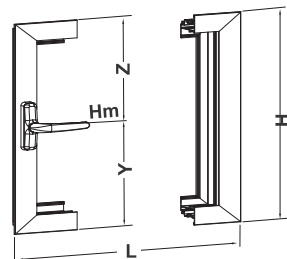
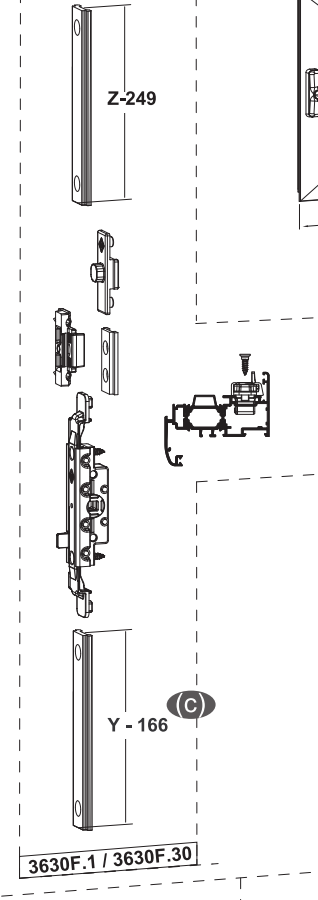
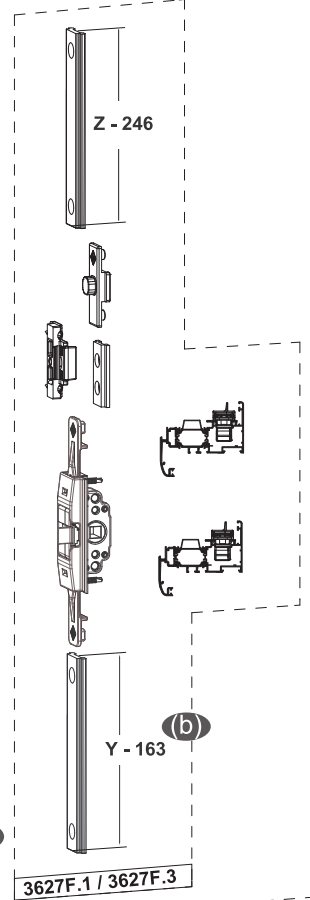
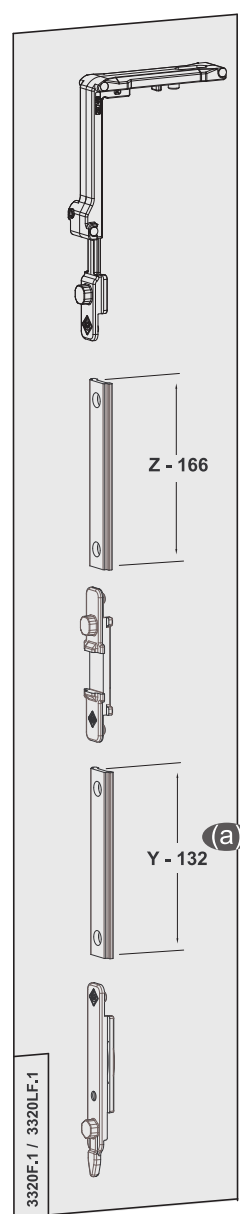
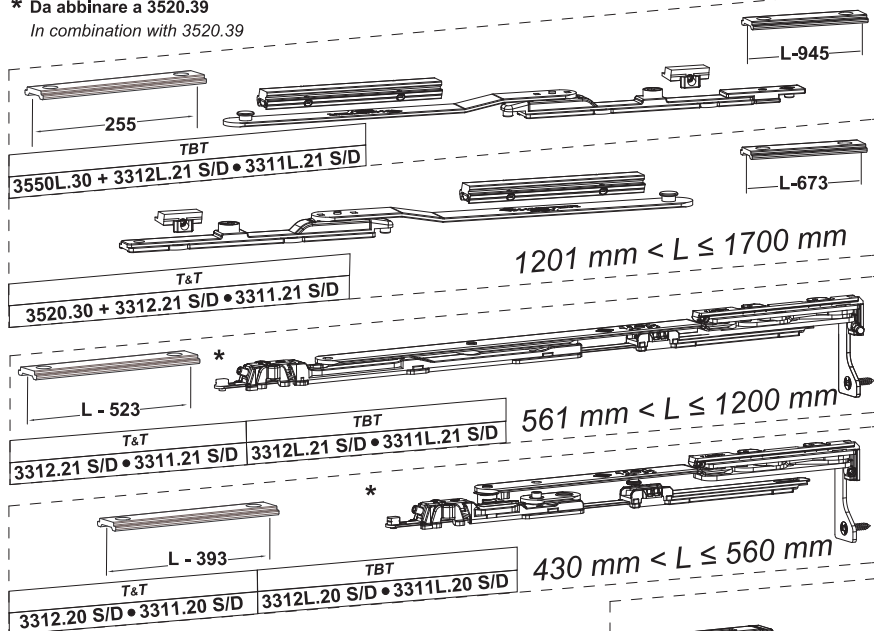

LOGICA DOPPIA ANTA
DOUBLE SASH
TBT

(a)	Y - 140
(b)	Y - 171
(c)	Y - 174

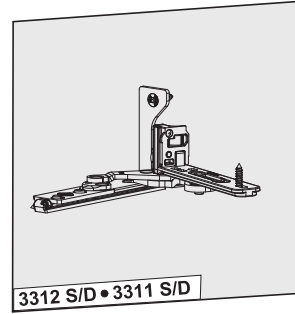
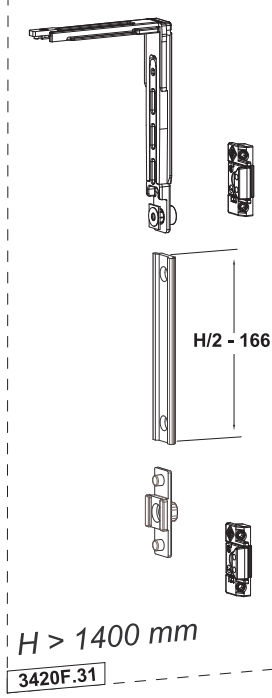

H > 1400 mm
3420F.31

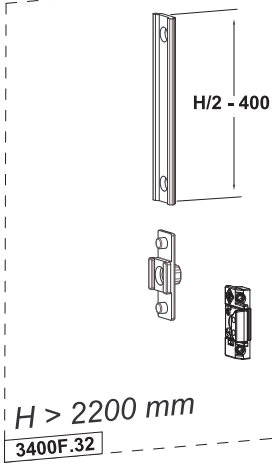
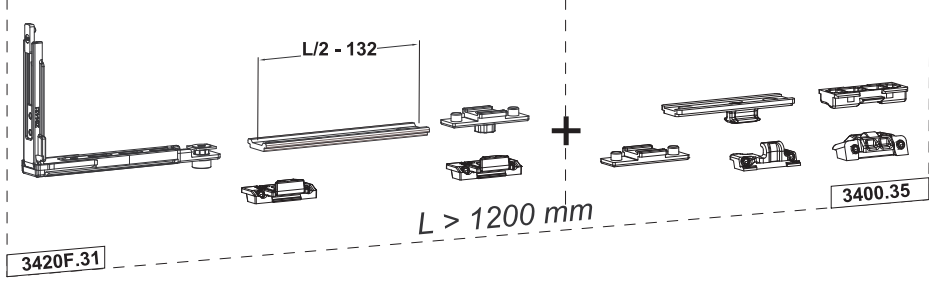

TELAIO - FRAME

ANTA - SASH

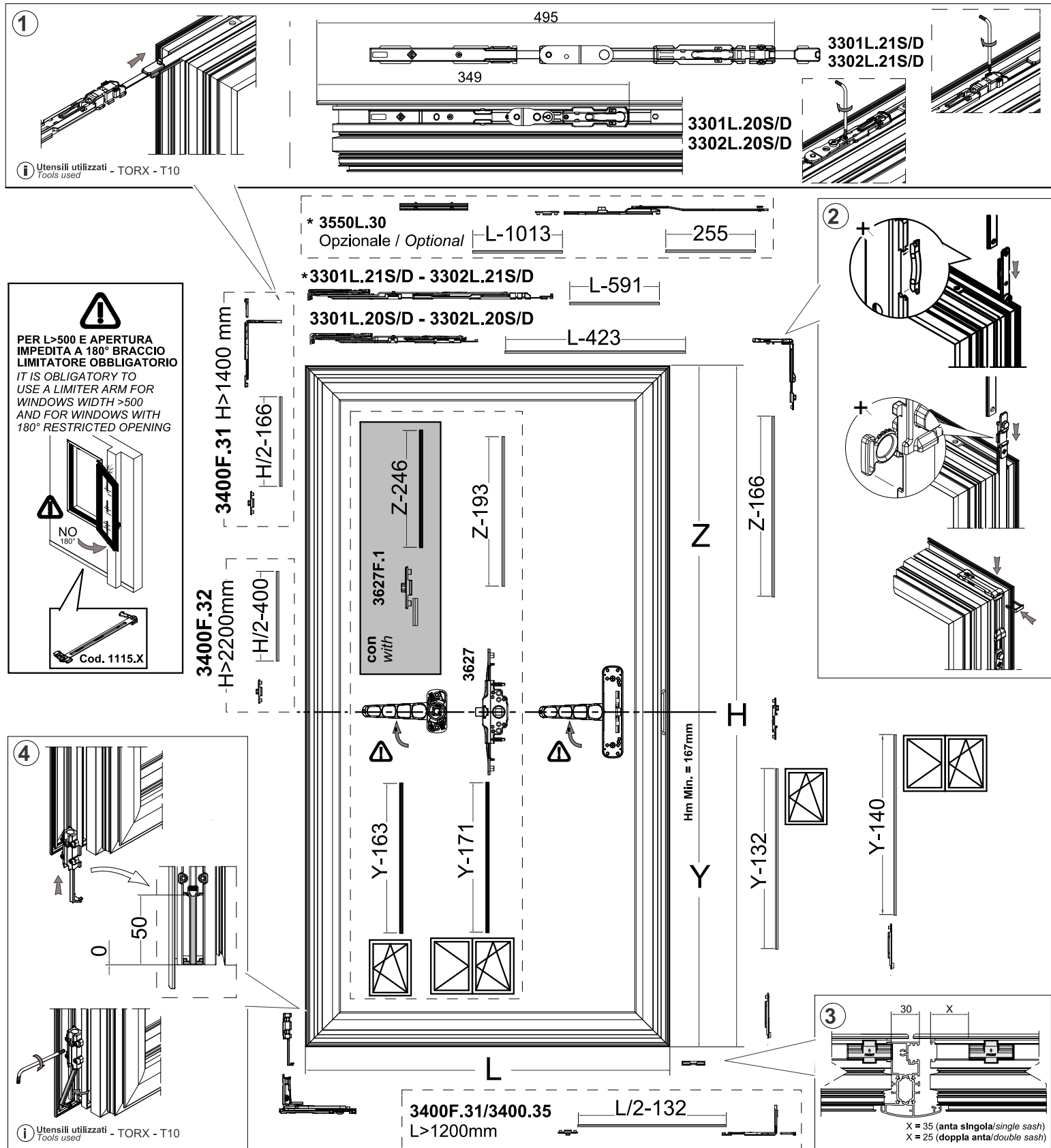
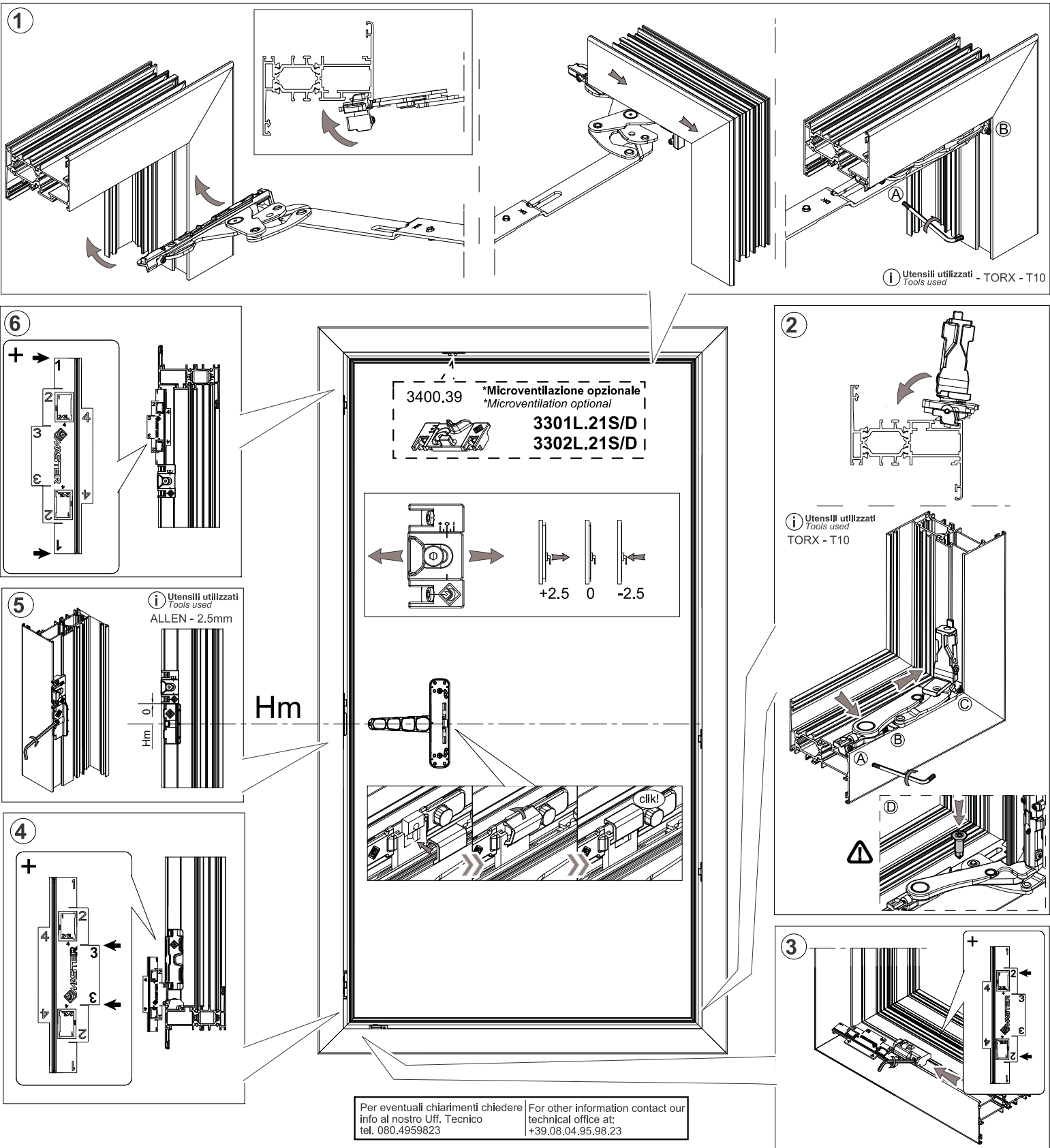

Indicazioni di montaggio / Assembling

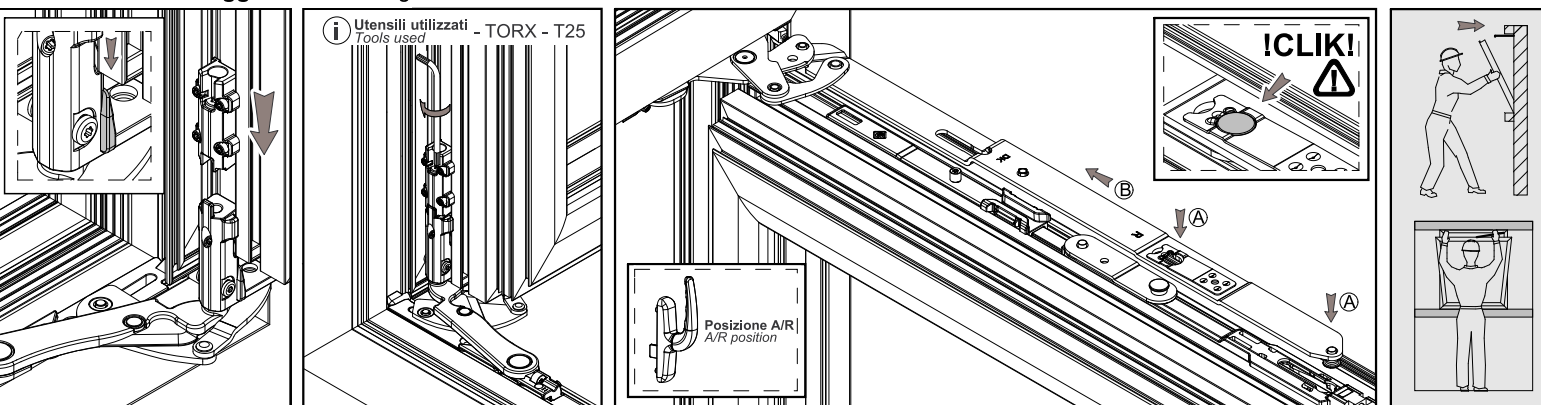

Regolazioni / Adjustments

