

REGOLAZIONE ADJUSTMENT

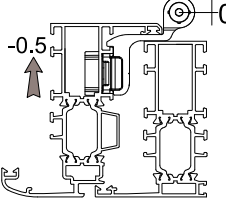

2700	50	41	35	30	26	23	21	19	17	16	15	14	13	12
2600	50	43	36	31	27	24	22	20	18	17	15	14	13	13
2500	50	45	37	32	28	25	22	20	19	17	16	15	14	13
2400	50	47	39	33	29	26	23	21	19	18	17	16	15	14
2300	50	49	41	35	30	27	24	22	20	19	17	16	15	14
2200	50	50	42	36	32	28	25	23	21	20	18	17	16	15
2100	50	50	44	38	33	30	27	24	22	21	19	18	17	14
2000	50	50	47	40	35	32	28	25	23	22	20	19	18	15
1900	50	50	49	42	37	33	29	27	25	23	21	20	17	16
1800	50	50	50	44	39	35	31	28	26	24	22	19	18	16
1700	50	50	50	47	41	37	33	30	27	25	21	20	19	17
1600	50	50	50	50	44	39	35	32	29	24	23	21	20	15
1500	50	50	50	50	47	41	37	34	31	26	24	22	18	13
1400	50	50	50	50	50	44	40	36	30	28	26	20	15	14
1300	50	50	50	50	50	48	43	35	32	30	23	17	16	10
1200	50	50	50	50	50	50	42	38	35	27	20	19	12	5
1100	50	50	50	50	50	50	46	42	32	23	22	14	6	X
1000	50	50	50	50	50	50	50	38	28	26	16	7	X	X
900	50	50	50	50	50	50	37	34	21	10	X	X	X	X
800	50	50	50	50	50	47	42	25	12	X	X	X	X	X
700	50	50	50	50	50	50	16	X	X	X	X	X	X	X
600	50	50	50	50	47	21	X	X	X	X	X	X	X	X
500	50	50	50	50	X	X	X	X	X	X	X	X	X	X
H L	395	500	600	700	800	900	1000	1100	1200	1300	1400	1500	1600	1700

Norma di riferimento Europea UNI EN 13126-1:2006 / 13126-3:2006 <i>Certified according to European Standard UNI EN 13126-1:2006 / 13126-3:2006</i>								
1550x1400	4	140	0	1	4	-	8	-
Dimensione di prova	Durabilità	Massa	Resistenza fuoco	Sicurezza di utilizzo	Resistenza alla corrosione	Resistenza effrazione	Applicazione	Categoria d'uso
<i>Test size</i>	<i>Durability</i>	<i>Mass</i>	<i>Fire resistance</i>	<i>Safety in use</i>	<i>Corrosion resistance</i>	<i>Security</i>	<i>Applicable part</i>	<i>Category of use</i>

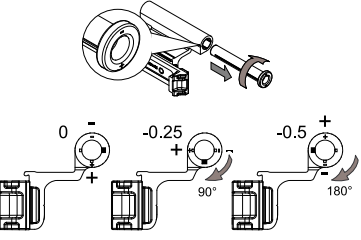
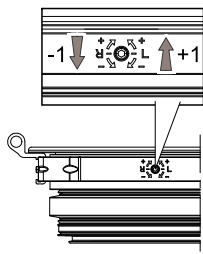

**3421G.1 / 3421G.40
3421G.151 / 3421G.401
3421LG.1**

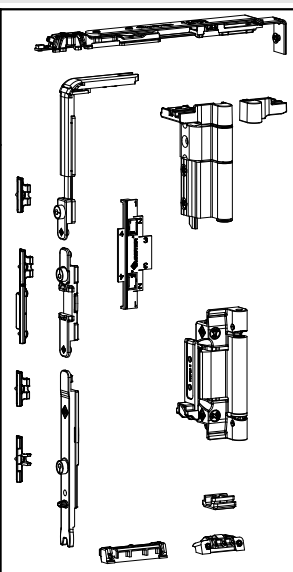

Technical drawing of a stepped shaft with dimensions in mm. The shaft has a total length of 28 mm, divided into three sections: 5 mm, 14 mm, and 5 mm. The diameters are 18 mm, 15 mm, and 8 mm. The drawing shows the shaft from the front and side views, with dimensions indicating the lengths of the sections and the diameters of the shaft.

A08

NOTA: nel caso di utilizzo cremonese con interasse 98mm utilizzare l'art. 6015.3

NOTA: nel caso di utilizzo cremonese con interasse 98mm utilizzare l'art. 6015.3

NOTE: in case of cremone-bolt with inter-axe 98mm use art. 6015.3

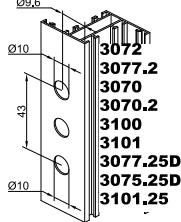
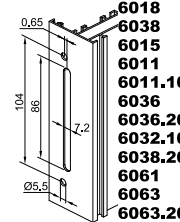

NOTE: in case of cremone-bolt with inter-axe 98mm use art. 6015.3

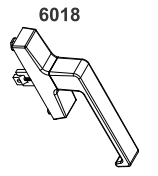

Technical drawing of a hole in a plate. The hole has a diameter of $\text{Ø}8$ and a distance of 10 from the bottom edge.

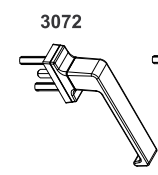

6038
6038.20D/S



3077.2
3077.25D/S



Master non risponde in alcun modo di possibili inesattezze imputabili ad errori di stampa e di trascrizione dati nel presente foglio.
Master does not bear any responsibility for possible inexactnesses due to printing mistakes or to transcription

Posizionamento punti chiusura kit base | Base kit locking points positioning

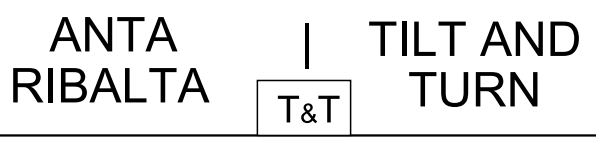

3421G.1 / 3421G.40 / 3421G.151 / 3421G.401

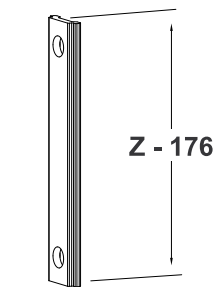
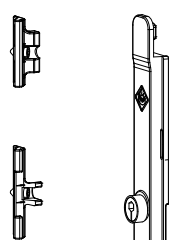
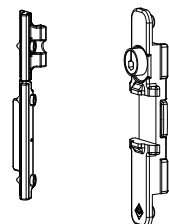
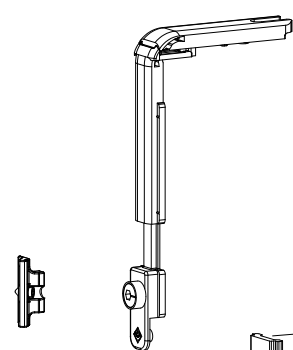

Y - 200

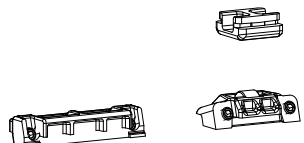

3421LG.1

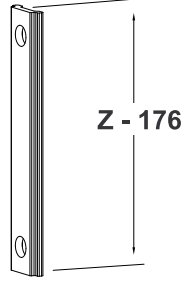
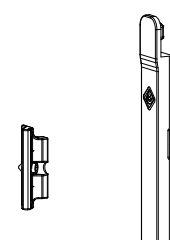
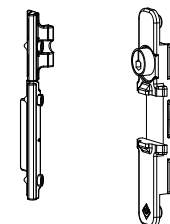
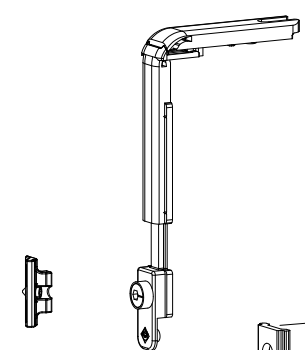

Y - 200

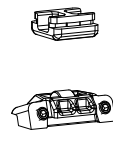
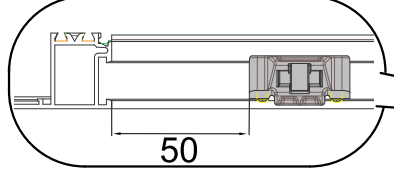

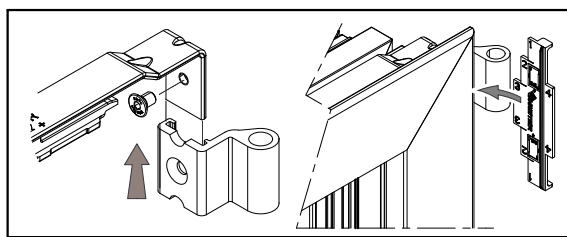

*Built-in microventilation pin
In combination with 3421.39*

