

**SCHEDA TECNICA DI MONTAGGIO**

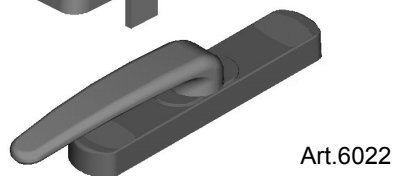

**CREMONESE APERTURA ESTERNA**

- Art. 6020.10 Universale
- Art. 6021.10 Universale con serratura
- Art. 6022 Universale - Ribassata

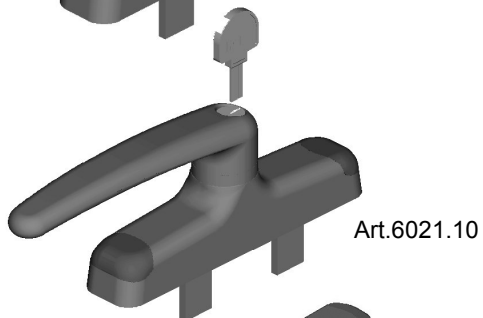
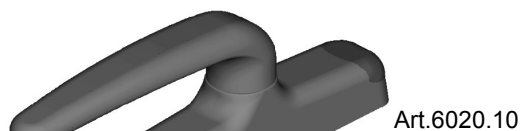

Da abbinare alle ns. macchinette per cremonese:  
 Art. 6415  
 Art. 6415A per serie arrotondate

Disponibili anche le versioni dotate di perni per  
 aggancio aste filettate:  
 Art. 6020.1 / 6021.1 / 6022.1 DX e SX

Utilizzabile con interasse 104 o 108 mm.



Per eventuali chiarimenti  
 chiedere info al nostro  
 Ufficio Tecnico  
 Tel. 080.4959823

**Inversione apertura**

Ruotare il manico di 90° ed aprire la cremonese

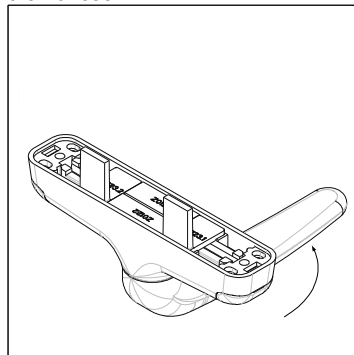

Invertire le pinne e richiudere

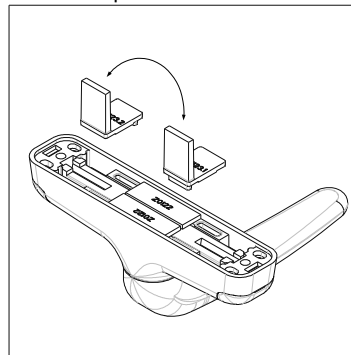

Posizione cremagliere apertura esterna destra.

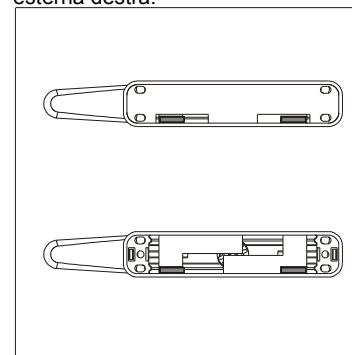

Posizione cremagliere apertura esterna sinistra.

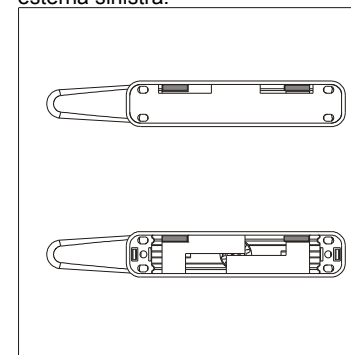

**Montaggio apertura esterna**

Eseguire le lavorazioni sui profili come qui indicato nelle fig. [1] o [2]

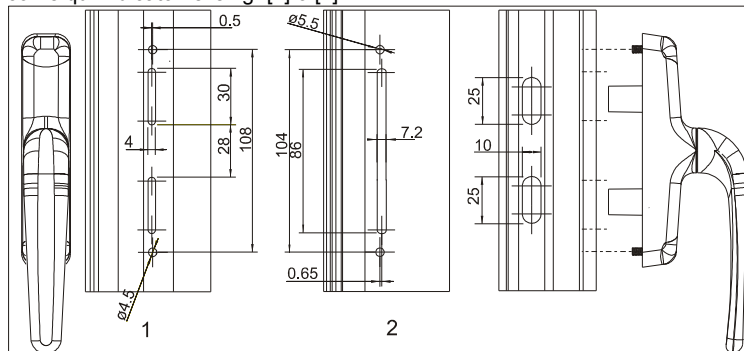

Infilare la macchinetta nel profilo, montare la cremonese avvitando le viti nei fori filettati predisposti sulla macchinetta. Infilare i tappi coprivite.

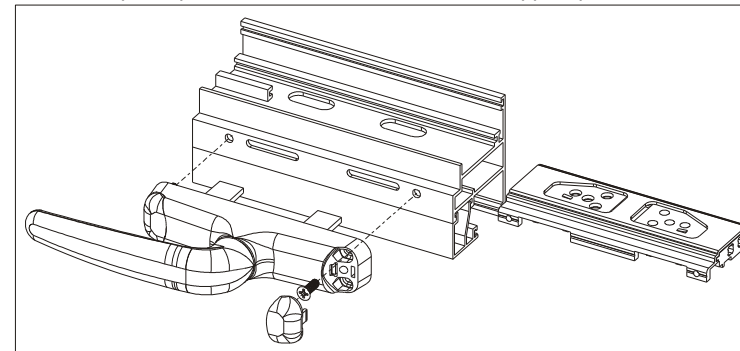

**Montaggio apertura interna**

Eseguire le lavorazioni sui profili come qui indicato:

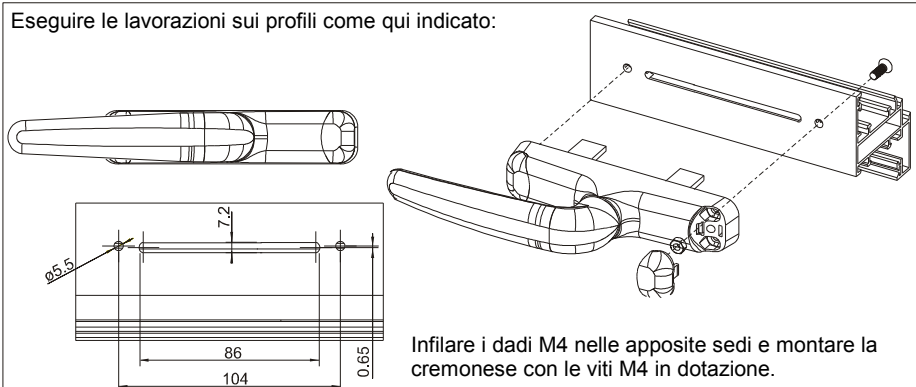

Infilare i dadi M4 nelle apposite sedi e montare la cremonese con le viti M4 in dotazione.

Lavorazioni per Art.: 6020.1/6021.1/6022.1

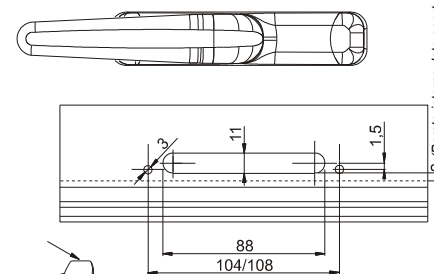

**Smontaggio tappi:**  
 Inserire dove indicato un cacciavite per facilitare lo smontaggio.

Master S.r.l. - 1031D - 16/05/2008  
 Master S.r.l. non risponde in alcun modo di possibili errori, omissioni o inesattezze imputabili ad errori di stampa o di trascrizione dati nel presente foglio.

# ASSEMBLING SCHEDULE



## CREMONE BOLT EXTERNAL OPENING

Art. 6020 Universal  
Art. 6021 Universal with lock  
Art. 6022 Universal - reduced

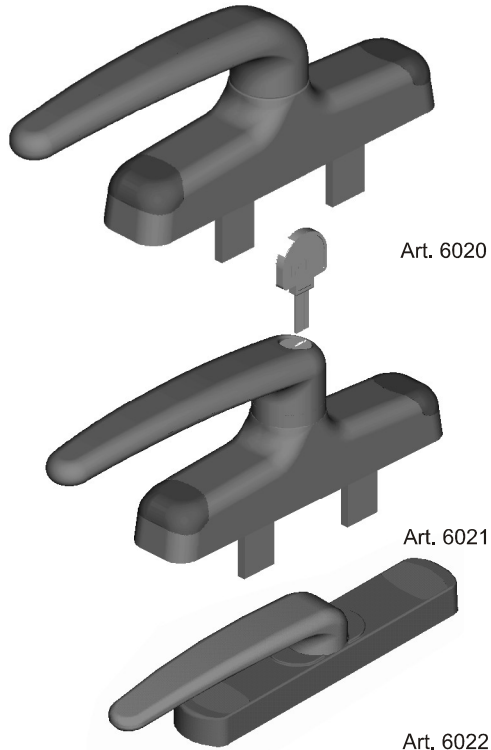

Art. 6020

Art. 6021

Art. 6022

To combine with our cremone-bolt machines:  
Art. 6415  
Art. 6415A for rounded series

The versions with provided pin for threaded rods claspings are also available:  
Art. 6020.1 / 6021.2 / 6022.1 Rh and Left  
It can be use with inter-axes 104 or 108 mm.



For other information ask to our Technic Office:  
Tel. +39.08.04.95.98.23

## Opening handle change

Turn the handle for 90° and open the cremone-bolt

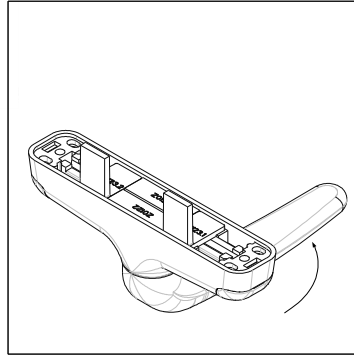

Change the wings position and close again.

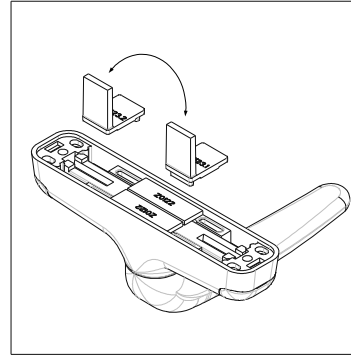

Position of the wings for right external opening.

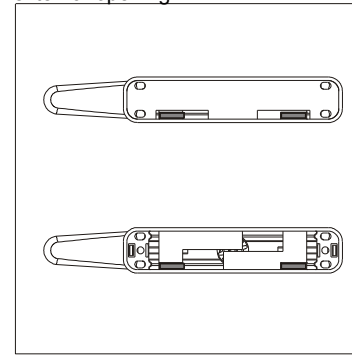

Position of the wings for left external opening.

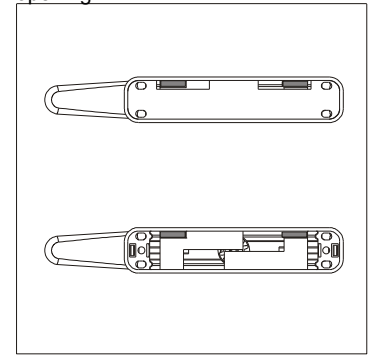

## External opening assembling

Insert the cremone-bolt machine in the profile, mount the cremone-bolt, screwing the screws in the threaded holes on the machine. Insert the cover-screw plugs.

Carry out the machining on the profiles as indicated in fig. [1] or [2]

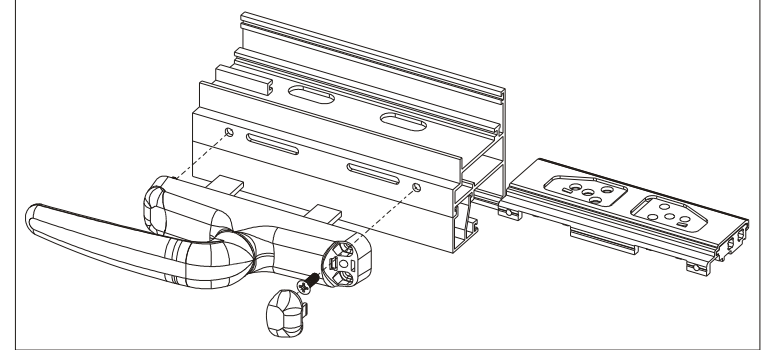
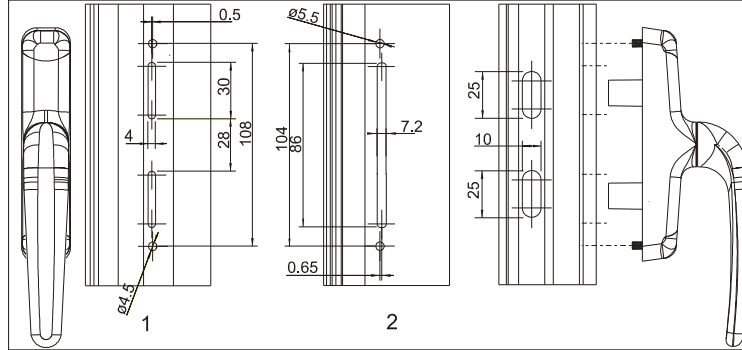

## Internal opening assembling

Carry out the machinings on the profiles as indicated here:

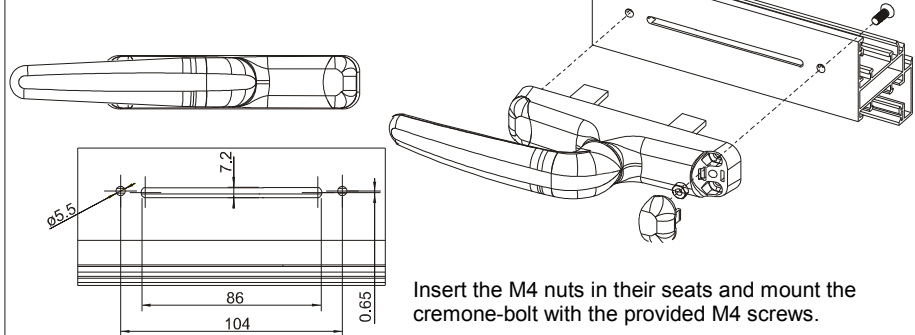

Insert the M4 nuts in their seats and mount the cremone-bolt with the provided M4 screws.

### Machinings for Art.: 6020.1/6021.1/6022.1

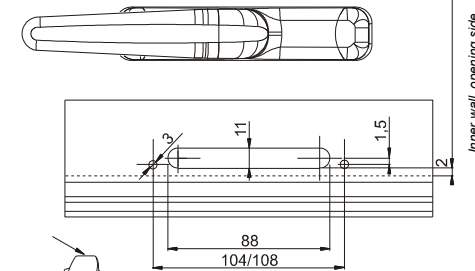

**Removing of the plugs:**  
Insert a screwdriver in the point indicated to make the dismantle easier.